

PLANNING
CONSENT
DRAWING

GORDON WEARMOUTH
(HOME)
31, NORLINTON CLOSE
ORLINGBURY
KETERING
NN14 1ED

ANNEXE IN CHAPEL STREET (ANNEXED LEGALLY TO THE HAVEN, KING ST. R.H. BAY Y022 4SH)
- ALSO KNOWN AS "WASH ROOM"

PLAN : 2011 / 0793 / FL

←----- 147 CMS ----->

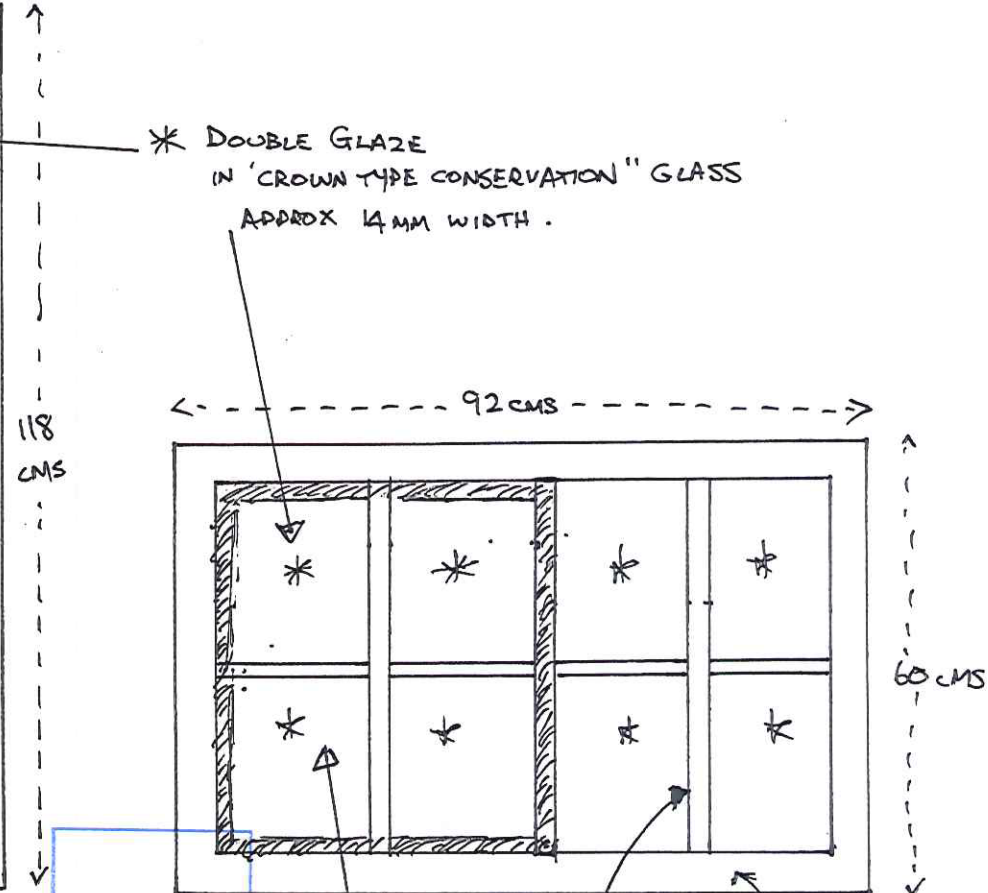
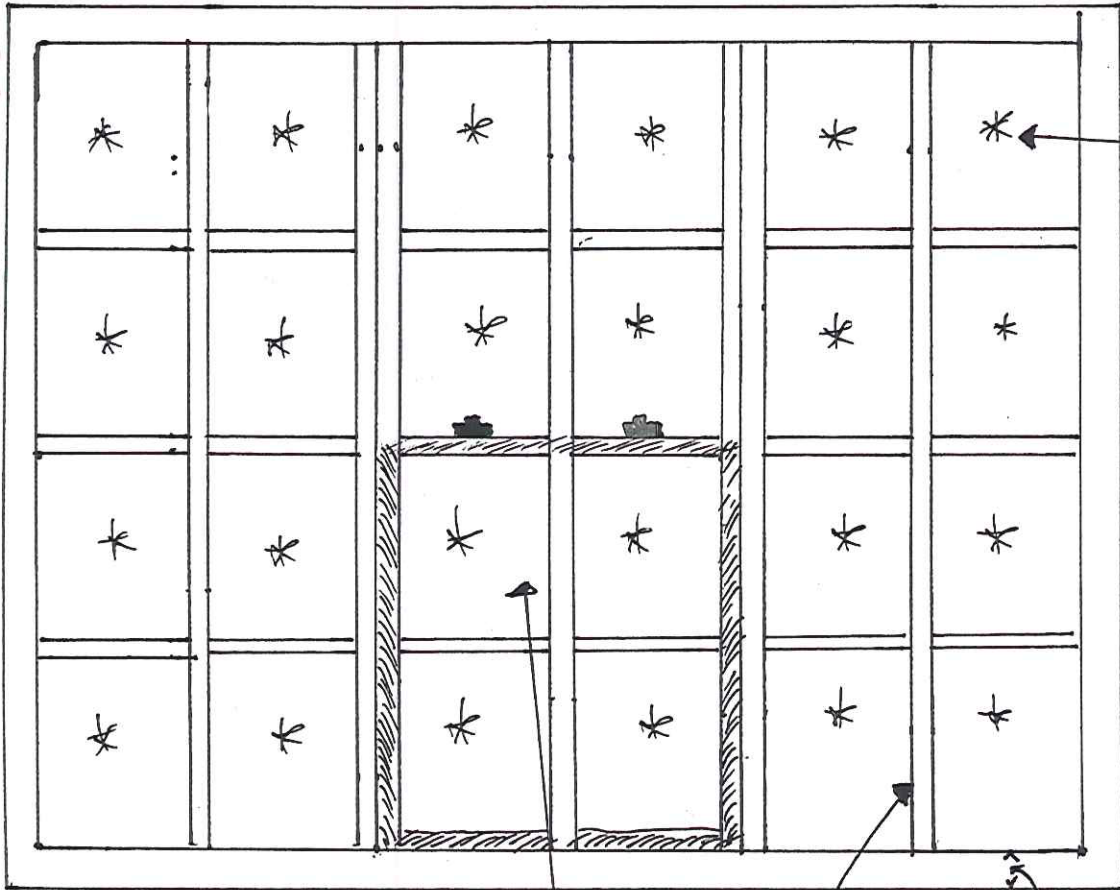

* DOUBLE GLAZE
IN 'CROWN TYPE CONSERVATION' GLASS
APPROX 14MM WIDTH.

DRAWING SCALE 1:10
10 CMS

SLIDING VERTICAL
SASH WINDOW
ALSO KNOWN AS A
'WHITBY COMPOSITE'

2.5CM
WIDE
5CM
x 8CM
PINE
FRAME

SLIDING HORIZONTAL
SASH WINDOW
"YORKSHIRE SASH"

2.5CM
WIDE
5CM
x 8CM
PINE
FRAME

28 NOV 2011

NVA/N/A

VERSION: 11/11/2011

EXISTING
VIEW OF WASH HOUSE WINDOWS
FROM NEW ROAD.

NOVEMBER 2011

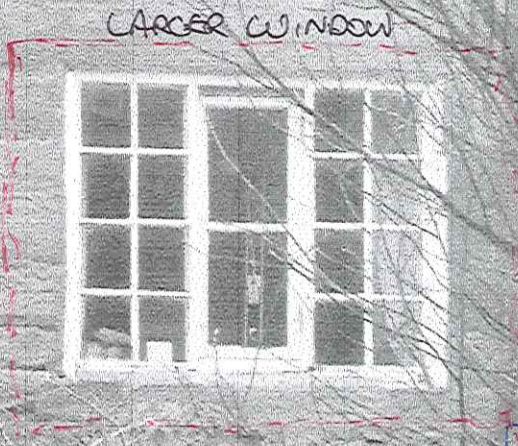
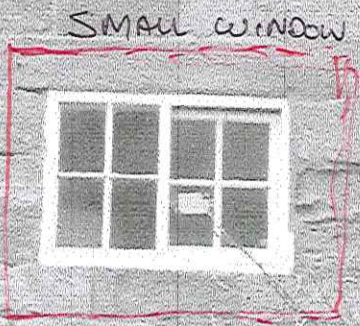

NVMMNPA
28 NOV 2011