



North York Moors National Park Authority
 The Old Vicarage
 Bondgate
 Helmsley
 York
 YO62 5BP

Telephone: 01439 770657
 Email: dc@northyorkmoors-npa.gov.uk
 Website: www.moors.uk.net

2012/0338

Application for approval of details reserved by condition.

Town and Country Planning Act 1990

Planning (Listed Buildings and Conservation Areas) Act 1990

185 # 11563
 28/5/12

Publication of planning applications on council websites

Please note that with the exception of applicant contact details and Certificates of Ownership, the information provided on this application form and in supporting documents may be published on the council's website.

If you have provided any other information as part of your application which falls within the definition of personal data under the Data Protection Act which you do not wish to be published on the council's website, please contact the council's planning department.

Please complete using block capitals and black ink.

It is important that you read the accompanying guidance notes as incorrect completion will delay the processing of your application.

1. Applicant Name and Address

Title: First name:

Last name:

Company (optional):

Unit: House number: House suffix:

House name:

Address 1:

Address 2:

Address 3:

Town:

County:

Country:

Postcode:

2. Agent Name and Address

Title: First name:

Last name:

Company (optional):

Unit: House number: House suffix:

House name:

Address 1:

Address 2:

Address 3:

Town:

County:

Country:

Postcode:

APPROVED
 28 MAY 2012
 SB

3. Site Address Details

Please provide the full postal address of the application site.

Unit: House number: House suffix:

House name:

Address 1:

Address 2:

Address 3:

Town:

County:

Postcode (optional):

Description of location or a grid reference.
(must be completed if postcode is not known):

Easting: Northing:

Description:

4. Pre-application Advice

Has assistance or prior advice been sought from the local authority about this application? Yes No

If Yes, please complete the following information about the advice you were given. (This will help the authority to deal with this application more efficiently).

Please tick if the full contact details are not known, and then complete as much as possible:

Officer name:

Reference:

Date (DD/MM/YYYY):
(must be pre-application submission)

Details of pre-application advice received?

5. Description Of Your Proposal

Please provide a description of the approved development as shown on the decision letter, including the application reference number and date of decision in the sections below:

Reference number: Date of decision: (Date must be pre-application submission) (DD/MM/YYYY)

Please state the condition number(s) to which this application relates:

| | | | |
|----|-----------------------------------|-----|-----------------------------------|
| 1. | 5, MATERIAL APPROVAL / STATEMENT | 6. | 18, PHOTO SURVEY / HIGHWAYS / TCL |
| 2. | 9, DRAINAGE DRAWINGS / ENGINEERS | 7. | 19, TCL TRAFFIC MANAGEMENT PLAN |
| 3. | 13, ENGINEERS DRAWINGS | 8. | |
| 4. | 15, ENGINEERS DRAWINGS / HIGHWAYS | 9. | |
| 5. | 17, TCL STATEMENT | 10. | |

Has the development already started? Yes No

If Yes please state when the development started (DD/MM/YYYY): (date must be pre-application submission)

Has the development been completed? Yes No

If Yes please state when the development was completed (DD/MM/YYYY): (date must be pre-application submission)

6. Discharge Of Condition

Please provide a full description and/or list of the materials/details that are being submitted for approval:

7. Part Discharge Of Condition(s)

Are you seeking to discharge only part of a condition? Yes No

If Yes, please indicate which part of the condition your application relates to:

8. Planning Application Requirements - Checklist

Please read the following checklist to make sure you have sent all the information in support of your proposal. Failure to submit all information required will result in your application being deemed invalid. It will not be considered valid until all information required by the Local Planning Authority has been submitted.

3 copies of a completed and dated application form:

3 copies of other plans and drawings or information necessary to describe the subject of the application:

9. Declaration

I/we hereby apply for planning permission/consent as described in this form and the accompanying plans/drawings and additional information.

Signed - Applicant:

Or signed - Agent:

Date (DD/MM/YYYY):

(date cannot be pre-application)

10. Applicant Contact Details

Telephone numbers

Country code: National number: Extension number:

Country code: Mobile number (optional):

Country code: Fax number (optional):

Email address (optional):

11. Agent Contact Details

Telephone numbers

Country code: National number: Extension number:

Country code: Mobile number (optional):

Country code: Fax number (optional):

Email address (optional):

12. Site Visit

Can the site be seen from a public road, public footpath, bridleway or other public land? Yes No

If the planning authority needs to make an appointment to carry out a site visit, whom should they contact? (Please select only one) Agent Applicant Other (if different from the agent/applicant's details)

If Other has been selected, please provide:

Contact name:

Telephone number:

Email address:





Tolent

TOLENT CONSTRUCTION LIMITED

Cleveland House,
Dukes Court,
Teesside Industrial Estate,
Thornaby,
Stockton on Tees, TS17 0LZ

20th April 2012

To Whom It May Concern

Re: Brick and Tile samples, Scraper Lane, Whitby

We have recently been appointed principle contractor for the new development on Scraper Lane, Stainsacre by our client Sanctuary Housing.

For your approval we have included four sample bricks proposed for the development and an alternative tile sample to the tile specified.

Carlton Brick manufactures all the brick samples included. The samples provided are the 65mm Crimson Dark Multi, 65mm Priory Mixture, 65mm Bretton Dragwire and 65mm Milltown Blend. We would be grateful if you could advise on which brick you would prefer to be used on the development.

The tile sample requested for approval is a Sandtoft Neo pantile. Also included is the Sandtoft Old English pantile specified.

Your opinions and advice on the proposed materials would be gratefully received.

Yours Faithfully

Andy Jackson
Sub Agent



2012/0369

5 NORTH HILL ROAD
HEADINGLEY
LEEDS
LS6 2EN

JM/422/01/LA.01
24th May 2012

Mrs Hilary Saunders
NYMNPA
The Old Vicarage
Bondgate, Helmsley
York
YO625BP

Dear Hilary,

RE: NYM/2011/0633/FL Construction of 6no. two storey affordable dwellings with associated parking.

Further to our correspondence relating to the above application, I enclose information related to the discharge of conditions. For clarity I have described the information in relation to conditions as numbered within the decision notice.

5. **Materials samples submitted to NYMNPA by Tolent Construction LTD (TCL)**
Samples include;
 - Brickwork, Carlton Red Multi
 - Tiles, Sandtoft Old English Pantile
 - Stone Cills/Heads/Water tabling, Natural York Sandstone
9. **NYMNPA require drainage details to be submitted for written approval;**
3no. copies AWP engineers drainage drawings attached
13. **NYMNPA require full set of engineers drawings;**
3no. copies of AWP drawings attached covering all requested information
15. **NYMNPA require engineers drawings to cover highways improvements, safety audit and programme of completion;**
3no. copies of AWP drawings attached covering all requested information
17. **NYMNPA require statement from TCL stating precautions to be undertaken on site to prevent dirt build-up on public highway;**
TCL statement attached
18. **NYMNPA require condition survey of highway;**
TCL have issued photographic archive of current site and highway imagery to Highways Department. TCL statement attached
19. **NYMNPA require TCL drawing showing proposed site layout;**
TCL site plan attached showing car parks, vehicle routes, offices, site compound and fire points



directors

KEITH W BREWSTER (managing)
BA(Hon) Dip Arch RBA
CHRISTOPHER LAUSTIN
BA(Hon) Dip Arch RBA

MARK HENDERSON
ABLAT

associates

MICHAEL I RUSHFORTH
Technical Manager
MATT SEDDON
BA (Hon) Dip Arch RBA
NATHAN WILKINSON
BA (Hon) B Arch RBA

Please find attached with hard copy only, cheque for £85 discharge fee.

Should you have any queries or require any further information please do not hesitate to contact me.

Yours sincerely

JONATHAN MCGEE

JonathanM@brewsterbye.co.uk

Cc Gareth Jackson – Brewster Bye Architects
Matty Russell – Tolent Construction LTD

File H:\CLIENTS\422 Tolent\01 Stainsacre\LA. LA\LA.01 Planners



Tolent

TOLENT CONSTRUCTION LIMITED

Cleveland House,
Dukes Court,
Teesside Industrial Estate,
Thornaby,
Stockton on Tees TS17 0LT

20th April 2012

To Whom It May Concern:

Re: Planning Conditions 17, Scraper Lane Stainsacre

Prior to the commencement of any construction works on site the main access road will be excavated to reduced levels and stoned up accordingly to prevent the deposit of any mud, grit or dirt onto the public highway.

During the construction of the access road we will be using road sweepers where appropriate to ensure the public highway is kept clean and free of site deposits.

A road sweeper will also be used if for any reason mud, grit or dirt is carried off site onto the public highway.

Yours Faithfully

Andy Jackson
Sub Agent





Tolent

TOLENT CONSTRUCTION LIMITED

Cleveland House,
Dukes Court,
Teesside Industrial Estate,
Thornaby,
Stockton on Tees TS17 0J T

20th April 2012

To Whom It May Concern:

Re: Planning Conditions 18 & 19, Scraper Lane Stainsacre

We have recently been appointed principle contractor for the new development on Scraper Lane, Stainsacre by our client Sanctuary Housing.

Planning condition 18 requests a survey recording the condition of the existing highway be carried out. Please find attached a disk containing photos taken on Friday 20th April 2012 showing existing highway conditions in and around Stainsacre.

Planning condition 19 requests the submission for approval of our proposals for on-site parking and on-site storage. For your approval please find attached our traffic management plan showing our proposed area for on site parking for all involved with the new development. Also shown on the plan is the material storage area for the development.

Your opinions and advice on our proposals would be gratefully received.

Yours Faithfully

Andy Jackson
Sub Agent



ASAMA BRICK & BLOCKS (Malaysia) Sdn Bhd
Carlton Brick
BRICK MANUFACTURERS

MVMMPA
28 MAY 2012

TRAFFIC Management For STAINSACRE

NOTE:
 ALL CO-ORDINATES ARE TO CORNER OF EXTERNAL WALLS.
 ALL CO-ORDINATES REFERENCED TO THE GRID SHOWN ON PLAN.
 ALL LEVELS ARE APPROXIMATE AND ARE FOR INFORMATION ONLY. EXACT F.F.L. TO BE CONFIRMED.
 G.C. IS RESPONSIBLE FOR ENSURING GRID REFERENCES ARE CONSISTENT WITH SITE DATA.
 THIS DRAWING IS TO BE USED FOR ESTABLISHING SITE COMPOUND, TEMPORARY HARDSTANDINGS AND REDUCED-LEVEL DIG ONLY

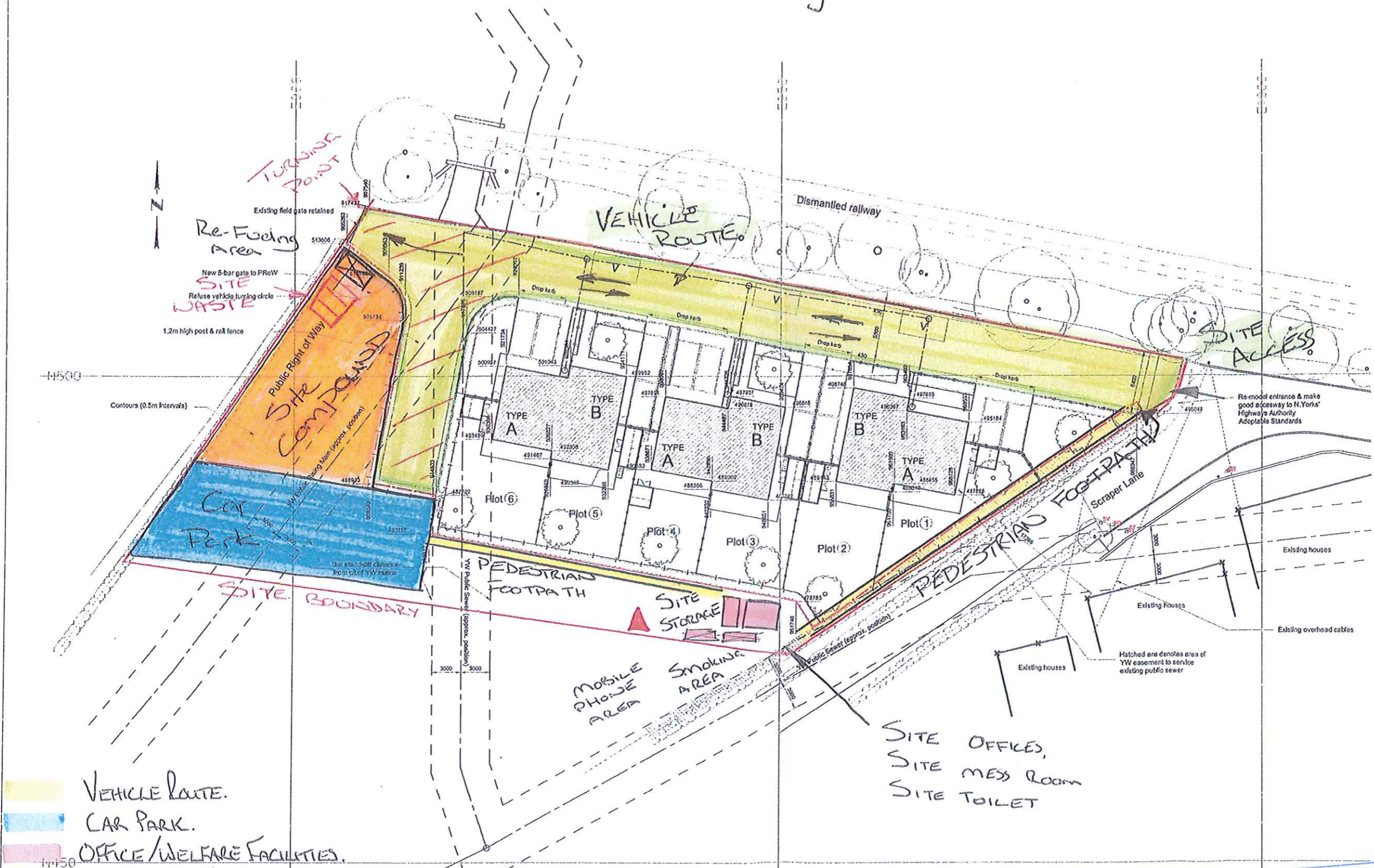

- VEHICLE ROUTE.
- CAR PARK.
- OFFICE/WELFARE FACILITIES.
- PEDESTRIAN FOOTPATHS
- SITE COMPOUND AREA
- ▲ FIRE MUSTER POINT.

APPROVED
 28 MAY 2012

| | |
|----------------------|---|
| PRELIMINARY DRAWING | |
| STAGE 1 | ✓ |
| Information/Comments | |
| STAGE 2 | |
| Construction | |

REVISIONS
 This drawing's copyright ©

 PROP'D FAMILY HOUSING
 SCRAPER LANE,
 STAINSACRE, N.YORKS.

PROPOSED SITE PLAN
 REDUCED LEVEL-DIG

Drawn: GJ Scale: 1:20000
 Date: 27.3.12 Checked:

 5 NORTH HALL ROAD
 HEADINGLEY
 LEEDS
 LS25EN

Dwg No: 02/16 (03)003 #