

Proposed Alterations to the Hackness Grange Hotel  
 Hackness, Scarborough, North Yorkshire  
 For: Mr. R. Brooks

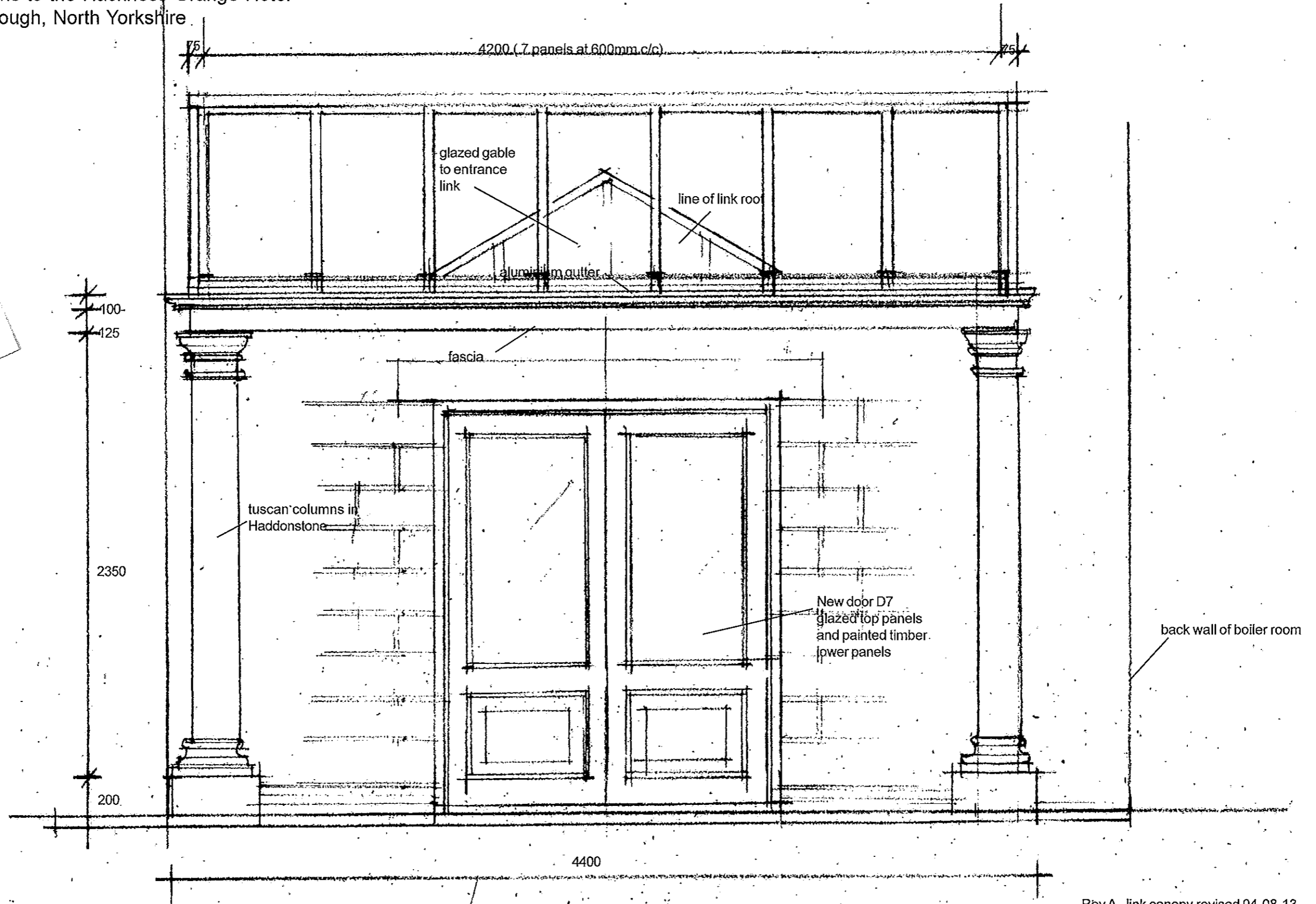

North West Elevation - Function Room Entrance Canopy

scale 1:50  
 date - July '13  
 ref. 13352/120B

Rev A - link canopy revised 04-08-13  
 Rev B - stonework round door shown 21-09-13

**Alan Campbell Chartered Architect**  
 Cliff Bridge Studio, 7 Cliff Bridge Terrace  
 Scarborough, North Yorkshire YO11 2JL

Proposed Alterations to the Hackness Grange Hotel  
 Hackness, Scarborough, North Yorkshire  
 For: Mr. R. Brooks

30 SEP 2013  
 10:53 AM

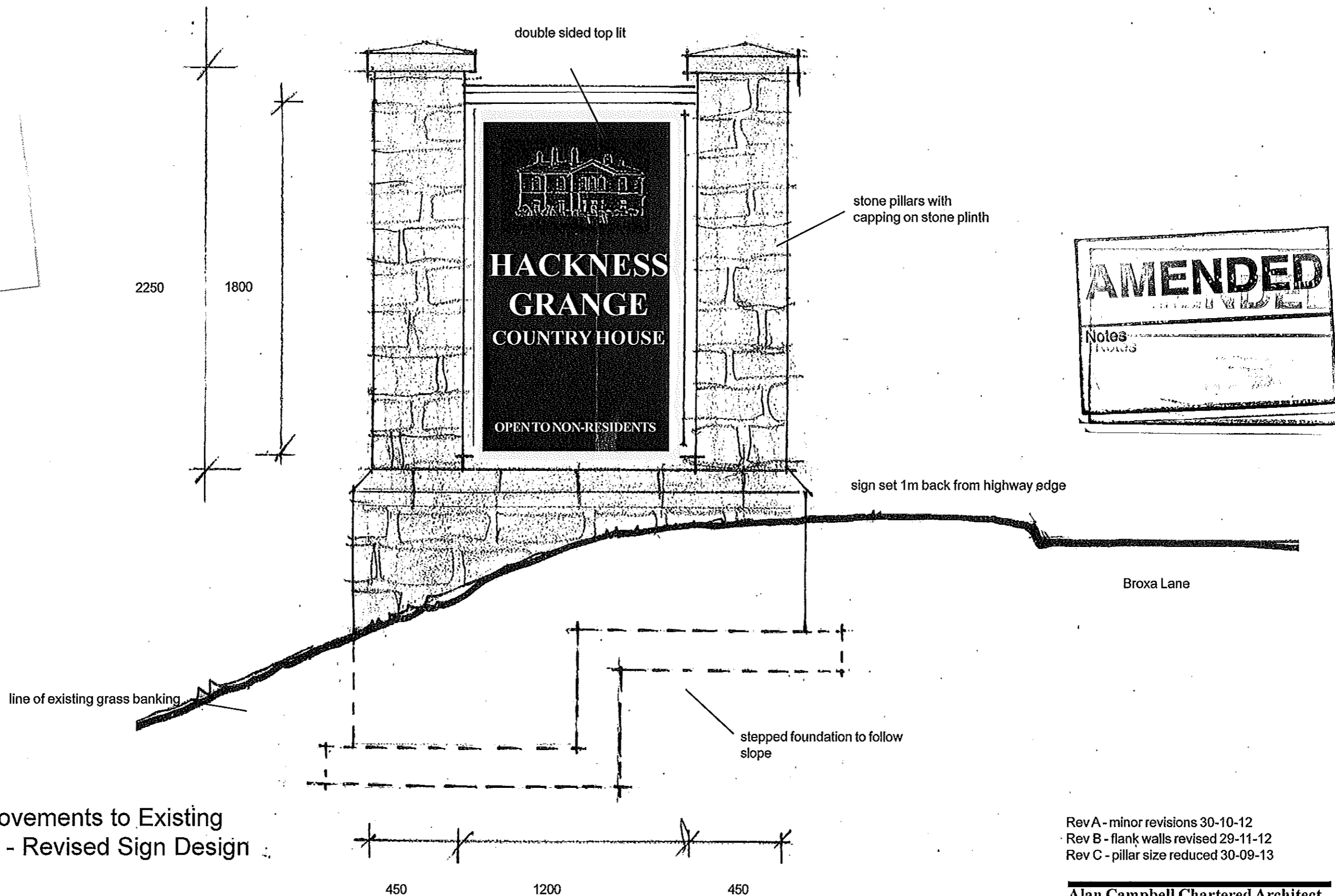

**AMENDED**

Notes

Proposed Improvements to Existing  
 Hotel Entrance - Revised Sign Design

scale 1:20  
 date - July '13  
 ref. 13352/121C

Rev A - minor revisions 30-10-12  
 Rev B - flank walls revised 29-11-12  
 Rev C - pillar size reduced 30-09-13

**Alan Campbell Chartered Architect**  
 Cliff Bridge Studio, 7 Cliff Bridge Terrace