

# DESIGN AND ACCESS STATEMENT

FOR  
PROPOSED LEAN-TO SHED  
AT  
ST. ATHANASIUS MONASTERY, LANGDALE END, SCARBOROUGH  
FOR  
Fr. ARSENIUS St. ATHANASIUS

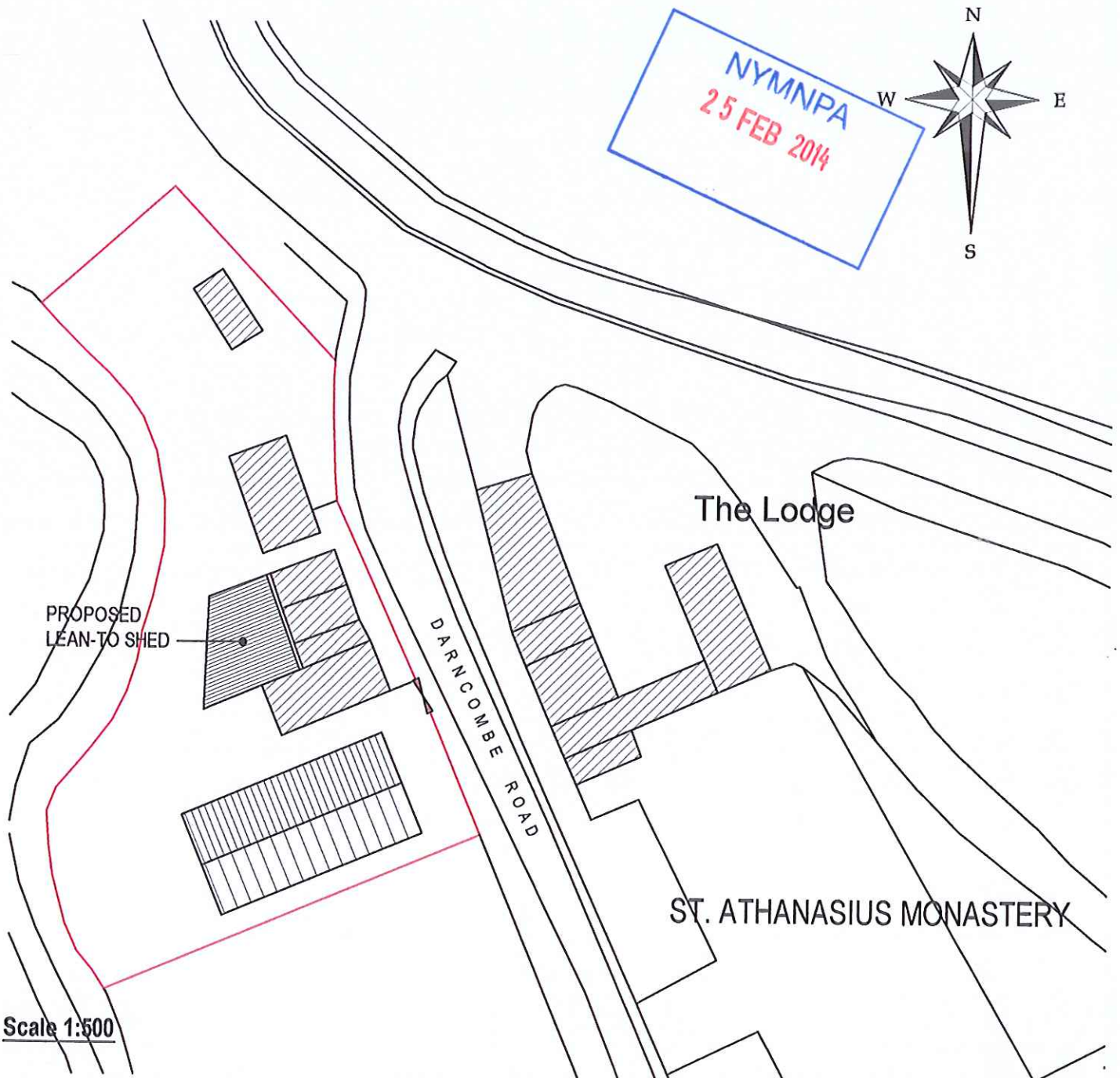

Scale 1:500

## CONTEXT

NYM / 2014 / 0123 / FL - 7

It is proposed to construct a steel framed shed with open sides and ends to provide covered space to accommodate cows and pigs. The existing lean-to shed would be removed.

The dimensions of the proposed building would be 18.000 m. long by 8.9 m. at the widest end 2.900 m. to eaves and 3.900 m. to the highest point.

The roof would be of steel profile sheeting natural grey colour.

The sides and ends would have precast concrete panels to 1.200 m. high with gates provided at both ends.

The floor of the building would be of concrete.

## AMOUNT OF DEVELOPMENT

The floor area of the building would be 125 sq. meters.

## LAYOUT

The layout is as shown on submitted plans.

## SCALE

All as shown on submitted plans.

## LANDSCAPE

No landscaping is proposed.

## ACCESS

Access to the proposed is by the existing gate.  
No public access is permitted on or through the site.



February 2014