

SHAWN RIGGS  
GLEN ESK RD  
RUSWARP  
YO22 5HL

OS MasterMap 1250/2500/10000 scale  
18 February 2014, ID: BW1-00298038  
www.blackwellmapping.co.uk  
1:1250 scale print at A4, Centre: 489238 E, 509081 N  
©Crown Copyright Ordnance Survey, Licence no. 100041049

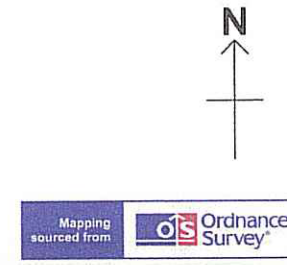

BLACKWELL'S  
www.blackwellmapping.co.uk  
TEL: 0114 268 7655  
maps.shelford@blackwell.co.uk

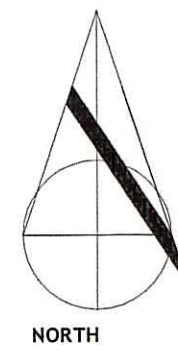

6

ROCK RETAINING WALL  
RETAINED HEIGHT 2.2m

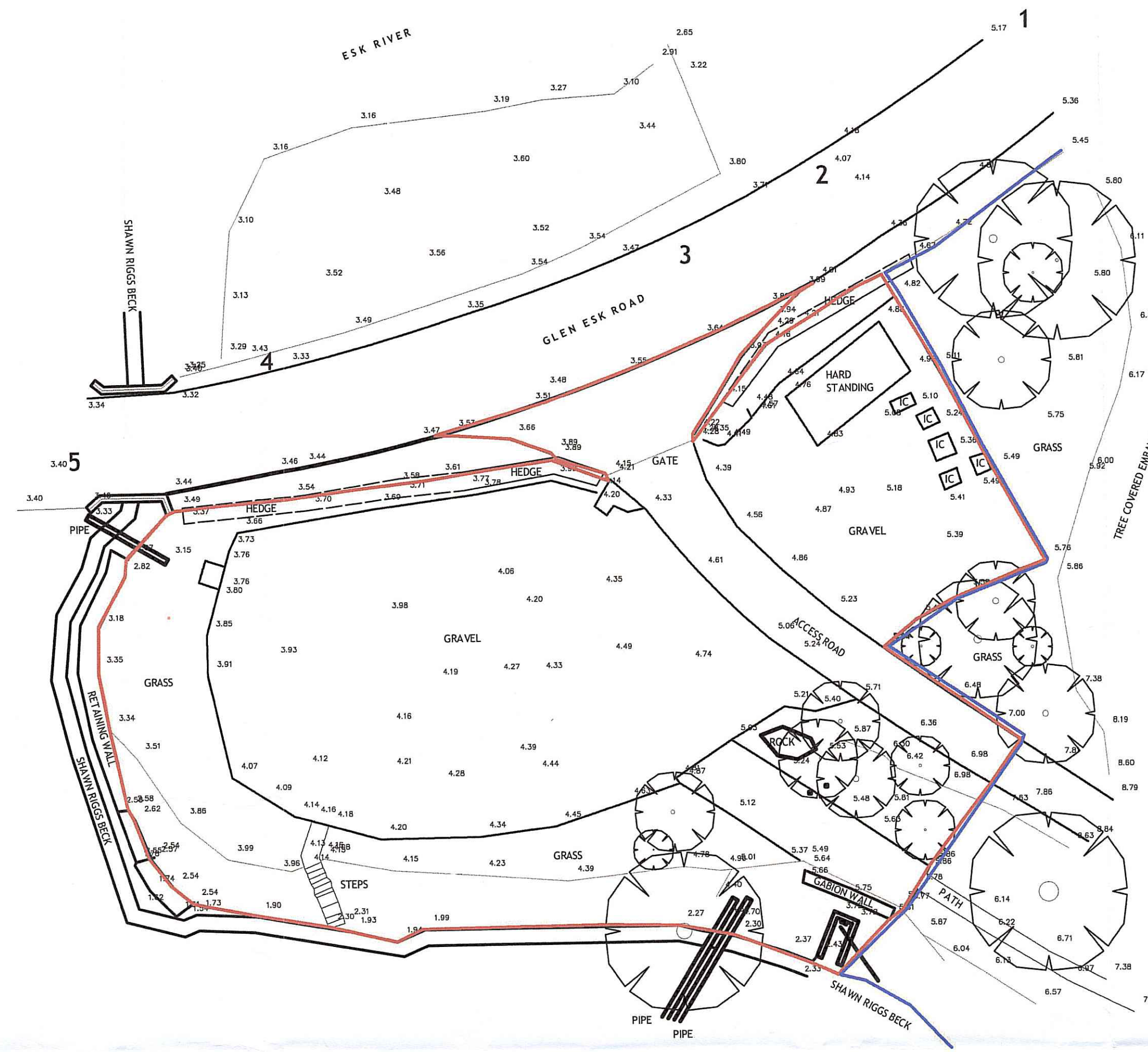

EXISTING 1:1250 LOCATION PLAN

1:200 EXISTING SITE PLAN

# JOURNEYMAN DESIGN

PROJECT SHAWN RIGGS  
GLEN ESK ROAD  
RUSWARP, WHITBY

CLIENT JEAN FERGUS

NYMNP  
13 JUN 2014

TITLE EXISTING LOCATION PLAN,  
SITE PLAN AND  
STREETSCENE PHOTOGRAPHS

STATUS	DATE	SCALE	REV
FEASIBILITY	17.02.2014	200 @ A1	-

DRAWING NO. SR PL-04

THIS DRAWING IS FOR PLANNING PURPOSES ONLY AND NO OTHER USE.  
ALL DIMENSIONS SHOWN ARE PROVISIONAL AND ARE SUBJECT TO ON SITE CONFIRMATION AT THE START OF THE CONSTRUCTION STAGE - ANY DISCREPANCIES ARE TO BE REPORTED TO THE EMPLOYER IMMEDIATELY. DO NOT SCALE FROM THIS DRAWING.

UNITY CENTRE, 85 BOLE HILL ROAD  
SHEFFIELD, S6 5DD

JOURNEYMANDESIGN.CO.UK

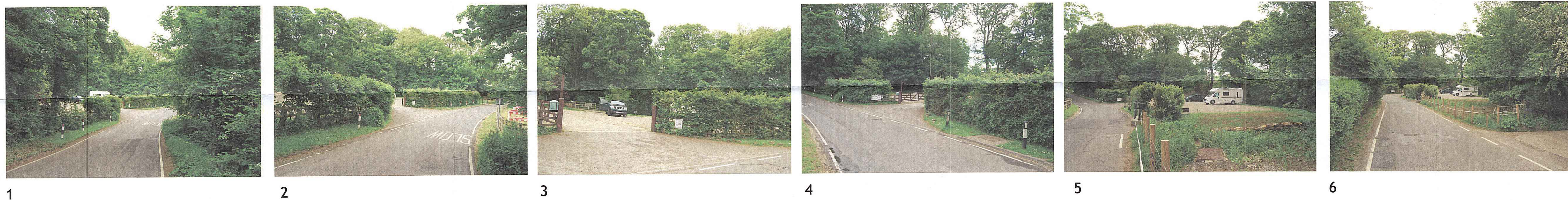

EXISTING SITE PHOTOGRAPHS