

Drawing PROPOSED GARAGE PROPOSED SITE LAYOUT	
date NOV 09	drawing no. 6
scale 1:100 APX	project no. W066/1
drawn PA, MT	revision
checked	

Malcolm Tempest Ltd.
 Architecture, Planning & Design
 HIGH PARKS, NEWTON-LE-WILLOWS
 BEDALE, NORTH YORKSHIRE, DL8 1TP

NYMNPA
 - 3 JUN 2014

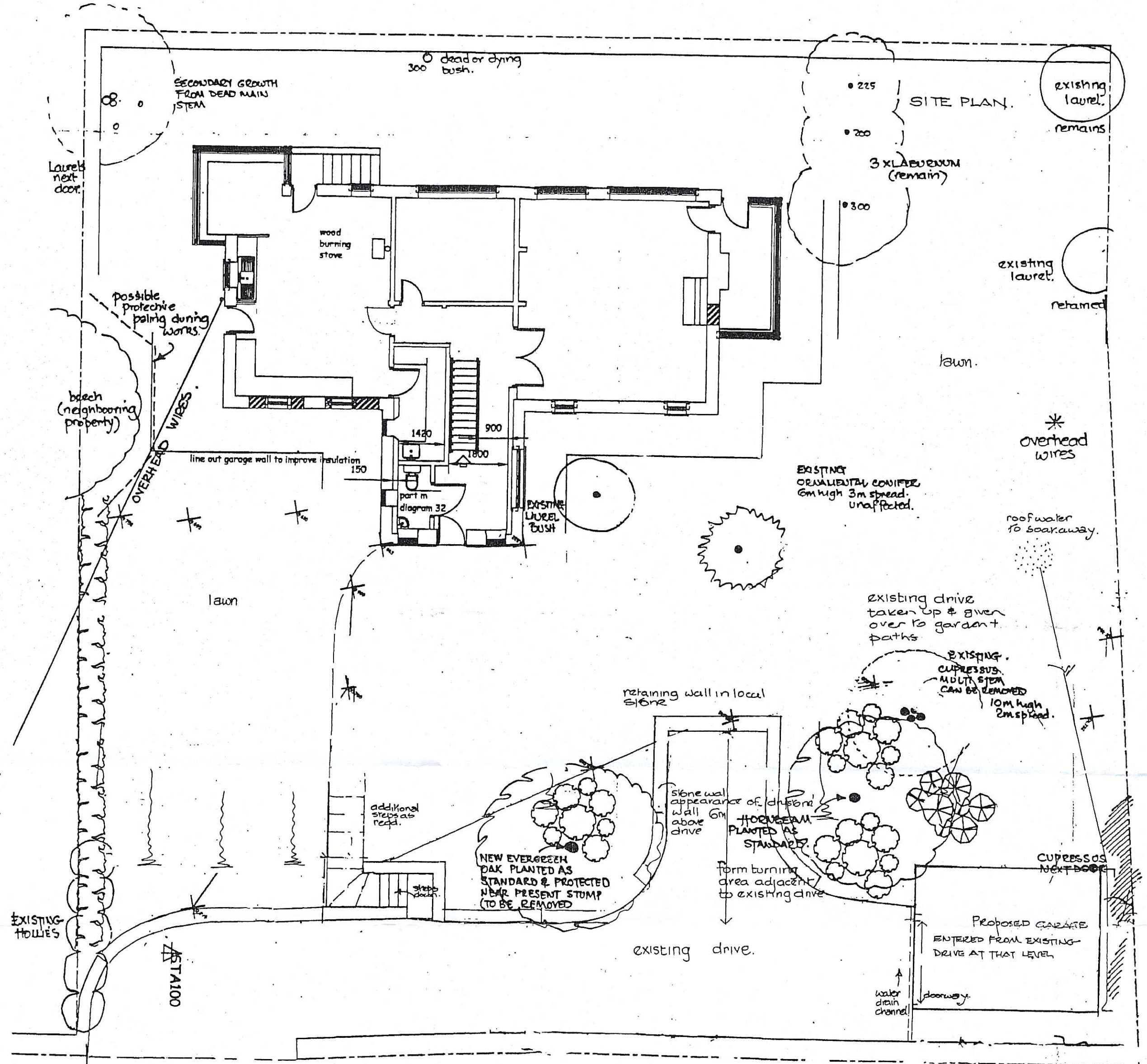

0 2 4 6 8 10m
 Originally drawn at 1:100

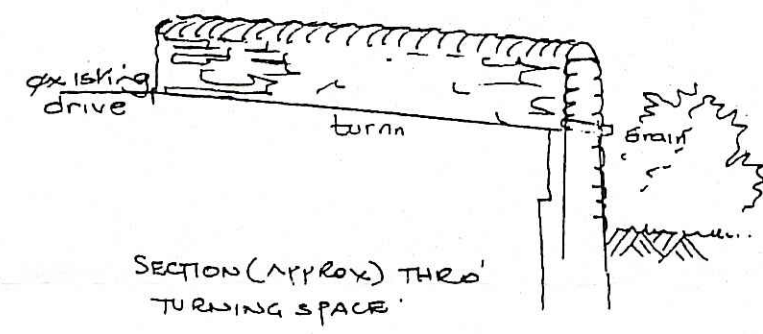

Project	PROPOSED GARAGE
Location	7 EGTON ROAD, AISLABY
Client	MR T WARD