

# DALTON COTTAGE TREE SURVEY & CONSTRAINT PLAN

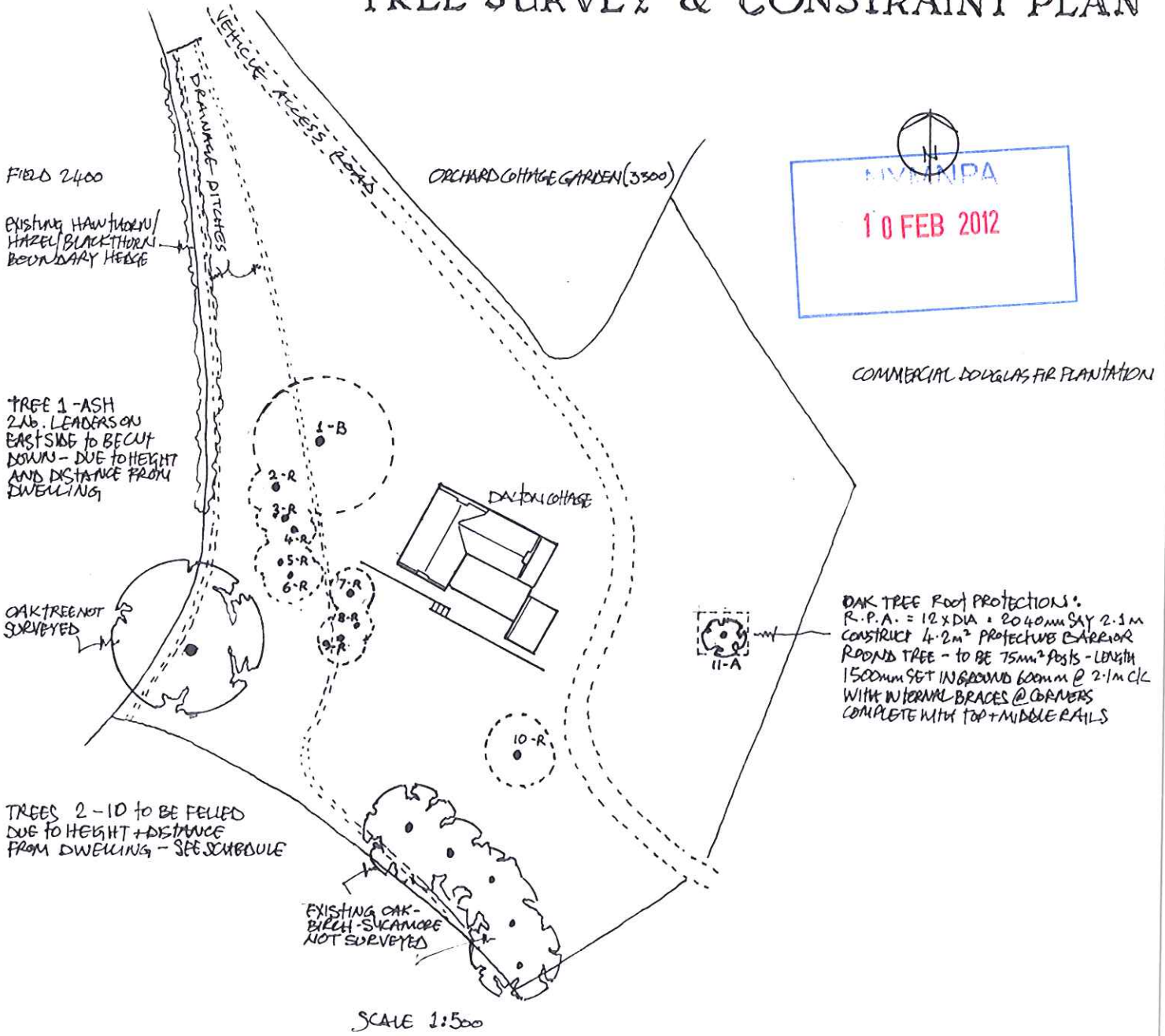

TO BE READ IN CONJUNCTION WITH TREE SCHEDULE

# DALTON COTTAGE TREE SCHEDULE

TREE REFERENCE No. [SEE SURVEY PLAN]	1	2	3	4	5	6	7	8	9	10	11	
SPECIES TYPE	- ASH - FRAXINUS EXCELSIOR	- DOUGLAS FIR - PSEUDOTSUGA TAXIFOLIA	- DOUGLAS FIR - PSEUDOTSUGA TAXIFOLIA	- DOUGLAS FIR - PSEUDOTSUGA TAXIFOLIA	- DOUGLAS FIR - PSEUDOTSUGA TAXIFOLIA	- DOUGLAS FIR - PSEUDOTSUGA TAXIFOLIA	- DOUGLAS FIR - PSEUDOTSUGA TAXIFOLIA	- CHERRY - PRUNUS AVIUM	- CHERRY - PRUNUS AVIUM	- CHERRY - PRUNUS AVIUM	- WILLOW - SALIX CAPREA	- OAK - QUERUS ROBUR
STEM DIA. (mm)	900 X 650 TAKEN @ 700 HT.	340	370	170	480	200	COPICED WITH STEMS OF 120-170-240	130	230	COPICED WITH 6STEMS OF	170	
APPROX. HEIGHT (M)	20	22	22	22	22	22	16	15	16	11	14	
CROWN SPREAD (M)	N-6 : E-7 S-5 : W-5	N-2 : E-2 S-1.5 : W-2.5	N-1.5 : E-2.5 S-1 : W-2.5	N-1.5 : E-2 S-2 : W-1.5	N-2 : E-2.5 S-1 : W-2	N-1 : E-2 S-2 : W-2	N-2.5 : E-3.5 S-3.5 : W-2	N-2 : E-2 S-1.5 : W-1.5	N-2 : E-3 S-3 : W-3	N-4 : E-4 S-5 : W-3.5	N-1 : E-1.5 S-2 : W-2	
HT. of CROWN CLEARANCE (M)	3	8	8	8	8	8	5	4	4	3	3	
AGE CLASS	MATURE	MIDDLE-AGED	MIDDLE-AGED	MIDDLE-AGED	MIDDLE-AGED	MIDDLE-AGED	MIDDLE-AGED	MIDDLE-AGED	MIDDLE-AGED	MATURE	YOUNG	
PHYSIOLOGICAL CONDITION	GOOD	GOOD	GOOD	FAIR	GOOD	FAIR	GOOD	GOOD	GOOD	POOR	GOOD	
STRUCTURAL CONDITION	SOUND	SOUND	SOUND	SOUND	SOUND	SOUND	SOUND	SOUND	SOUND	PRESENCE OF DECAY FALLEN STEM	SOUND	
CATEGORY GRADING	- B - MEDIUM VALUE	- R - TO BE REMOVED	- R - TO BE REMOVED	- R - TO BE REMOVED	- R - TO BE REMOVED	- R - TO BE REMOVED	- R - TO BE REMOVED	- R - TO BE REMOVED	- R - TO BE REMOVED	- R - TO BE REMOVED	- A - HIGH QUALITY	
DISTANCE FROM DWELLING	11.5	12	10	8.5	10	9	5	6.5	8	9	14	
ACTION DETAILS	MAIN TRUNK SPLITS INTO 4 LEADERS AT 1.2m ABOVE G. 2 No. EAST STEMS LEANING TOWARDS DWELLING TO BE CUT BACK TO MAIN TRUNK	ALL TO BE FELLED DUE TO THEIR HEIGHT AND PROXIMITY TO DWELLING									R.P.A (ROOT PROTECTION AREA) REQUIRED AND BARRIER Erected DURING CONSTRUCTION PERIOD	

TO BE READ IN CONJUNCTION WITH TREE AND CONSTRAINT PLAN

NYMANIPA  
 10 FEB 2012

NYM / 2011 / 0850 / FL 3