

# Design and Access Statement

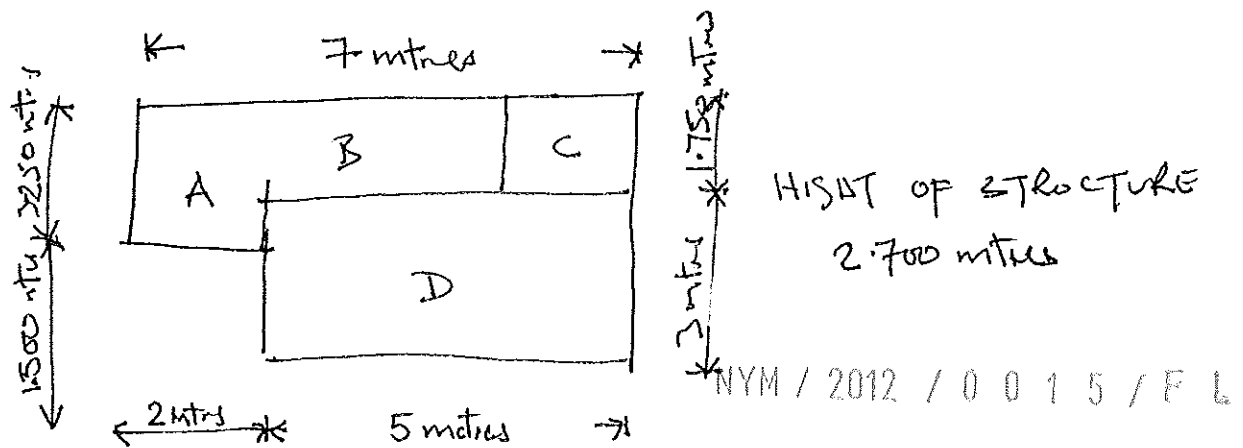

A and B garden store and Potting area.

C. Toilet

D. Summerhouse.

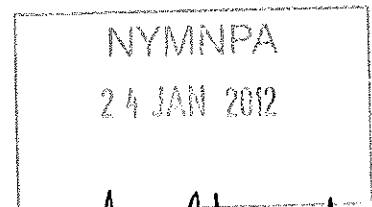

The proposed structure would be built of wood tongue and groove boards over a wood frame.

The floor would be of decking boards over a 50 mm x 100 mm cross braced structure

The roof would be of 50 x 100 mm timbers clad with 18 mm x 125 mm boards and covered with green mineral felt.

The windows would be wood framed, half glazed opening lights to front & side only. Doors would be wood framed boarded and half glazed.

The structure would be painted with a wood preservative - Cuprinol - colour Wild Thyme - this green finish chosen to blend in naturally with the surroundings.

Design and Access Statement continued for  
Garden structure at Orchard Cottage Eglon Bridge.

The decision of where the structure was to  
be sited was made to discreetly replace  
three rotting sheds up one side of the  
gardens.

NYM / 2012 / 0015 / FL 1

NYMNDA

24 JAN 2012

The siting of the new structure cannot be  
seen by most windows from Orchard Cottage  
and in no way will obscure or deter  
from the cottage's lovely views.

However where the structure will be sited  
there is easy and unobtrusive access to the  
existing cottage with uninterrupted views from  
the structure over all of the beautiful  
gardens. This project will not only enhance  
the location but be much appreciated and  
used during our present and future retirement  
years.

Please note finally the site does not involve  
any public access or no where near a road.  
We have taken into account the Disability  
Discrimination Act in view of that fact if  
my husband's health deteriorates he will still  
be able to enjoy easy access to the  
structure from the cottage. The septic tank  
is by the proposed structure and easy to  
allow a garden toilet for him as only two of us