

2012 / 2012 10 27 9

PHOTOGRAPH 01
SHOWING EXAMPLE OF
EXISTING DORMER TO BE
REFURBISHED WITH SOLIO SIDES
XCABLE WITH LIME RENDER FINISH.



NYMNP
27 APR 2012

NYM / 2012 / H 279 / LB

POSITION OF PROPOSED TRACK FROM 5 BAR GATE ON BOUNDARY TO 5 BAR GATE TO FIELD. TO BE A TWIN TRACK HARDCORE WITH GRASS CENTRAL



Troutdale Beck

Troutdale Mill

Foot Bridge

Castle Grid

NYMNPA
27 APR 2012

PLAN OF PROPOSED TRACK



Plan no: EXT 03

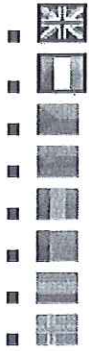

NYM / 2012 / 0 2 7 9 / L B

Select your location

Clarehill Plastics Limited



Promoting excellence in oil heating, cooking and storage. Supported by Harlequin.

Search this site...

Go

2000ITE Bunded Oil Tanks with Built-In Intelligence



Length: 2360 mm
Width: 1320 mm
Height: 1415 mm
Weight: 180 kg
Actual Capacity: 2110 litres
Nominal Capacity: 2005 litres

ERA Ratings

ERA is a new initiative that allows you to quickly and easily compare the relative risk of an environmental pollution incident originating from different types and different designs of fuel tanks and oil tanks. For more information, visit www.eraratings.org.uk.

This tank is rated as follows:





NYM / 2012 / 0 2 7 9 / L B

OUTLET POSITION: Bottom Outlet



Product Summary

Bunded Plastic Oil Tank rotationally moulded from premium grade, oil resistant Medium Density Polyethylene. Ideal for the storage of Home Heating Oil and supplied complete with:

- 2" Lockable Fill Point with Screw Cap
- 4" Lockable Inspection Aperture with Plastic Screw Cap
- 2" Vent
- Lockable Manhole Access
- Oil Tank Contents Dipstick
- **i-Track IT000 Intelligent Oil Monitoring Technology (Displays litres of oil remaining, tank contents as a percentage of overall capacity, number of days to empty, date/time, internal temperature and oil storage temperature)**
- LRC Failsafe Overfill Prevention Capability
- Lockable Manhole Access
- 1" BSP Bottom Outlet complete with Oil Tank Fitting Kit*please note, top outlet image shown is for display purposes only. iTank Evo models will come as bottom outlet
- 'This Tank is Alarmed' Sticker

Applications

Bunded Oil Tank suitable for the storage of heating oil at above ground storage installations at agricultural, commercial, domestic, industrial and institutional premises. Satisfies or exceeds all applicable oil storage tank requirements detailed within:

- The Control of Pollution (Oil Storage) (England) Regulations 2001
- The Control of Pollution (Silage, Slurry and Agricultural Fuel Oil) Regulations 1991
- The Control of Pollution (Silage, Slurry and Agricultural Fuel Oil) Regulations (Northern Ireland) 2003
- The Water Environment (Oil Storage) (Scotland) Regulations 2006
- Environmental Alliance Pollution Prevention Guidelines PPG 2
- Oil storage tank installation requirements contained within Building Regulations throughout the UK and Republic of Ireland

Please note that this Bunded Oil Tank is unsuitable for connection to a fuel delivery system incorporating a flexible hose and trigger nozzle. Please refer

Tankmark is a nationwide network of independent storage tank technicians who can provide the complete tank installation and replacement service.

[Click here](#) to arrange a free no obligation, no hassle quotation for the supply and installation of your new Harlequin tank.

Important Information All

Harlequin bunded oil tanks must be installed and maintained by a competent person, in accordance with manufacturer's instructions and prevailing statutory requirements. Clarehill Plastics Limited will not be responsible for installations that do not conform to these requirements. Please note that all images are supplied for reference purposes only. All dimensions and capacities stated are approximate and are understood to be correct at time of publication. However consistent our commitment to continual product improvement, the right is reserved to amend products without notice. Nominal capacities stated are equivalent to 95% of brimful volume.



PHOTOGRAPH 02
SHOWING STONE WALL
AROUND COURTYARD
NYM / 2012 / 0279 / LB



PHOTOGRAPH 03
SHOWING OLD APPLE TREE
MARKED T1

NYM / 2012 / 0 2 7 9 / 1 B

NYMNPA
27 APR 2012

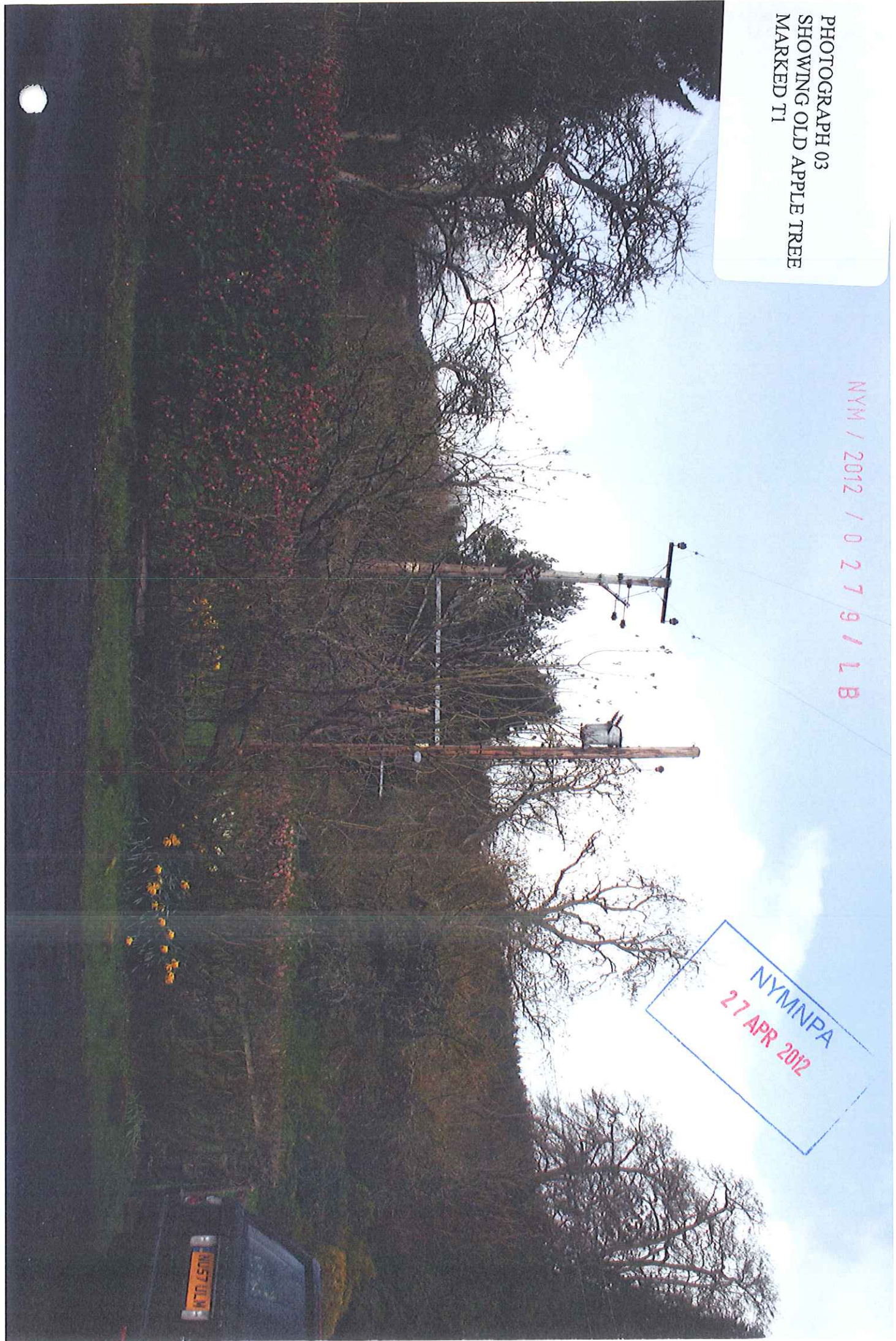

PHOTOGRAPH 04
PROPOSED STONE WALL
LENGTH 10.3M (A)
HEIGHT 1.3M DEPTH 450mm
HAND GATE 1.2M

NYM / 2012 / 0279 / LB

NYMNP
27 APR 2012



PHOTOGRAPH 05
SHOWING EXISTING
FIREPLACE

NYM / 2012 / U 27 9 / L B



NYM / 2012 / 027

PHOTOGRAPH 06
SHOWING PART OF PANTRY
WALL FOR PROPOSED
REMOVAL



NYM / 2012 / 0 2 7 9

PHOTOGRAPH 07
SHOWING MILL DOOR

NYMNP
27 APR 2012



NYM / 2012 / 0 2 7
PHOTOGRAPH 08
SHOWING WINDOWS
MARKED 2 & 3 AT GABLE
END FOR PROPOSED
REPLACEMENT

NYMNP
27 APR 2012

BALANCED FLUE FROM
BOILER ON OUTHOUSE
WALL POSITION APPROX
900mm HIGH / 300mm DEPTH



NYM / 2012 / 0279 / LB
PHOTOGRAPH 09
PROPOSED KENNEL
6.14M LONG/ 3.03M WIDE
2.1M AT HIGHEST POINT

NYMNP
27 APR 2012



PHOTOGRAPH 10
PROPOSED AGA FLUE
MAXIMUM 600mm ABOVE
RIDGE HEIGHT DEPENDING
ON DOWNDRAUGHT

NYM / 2012 / 0 2 7 9

NYM/NPA
27 APR 2012

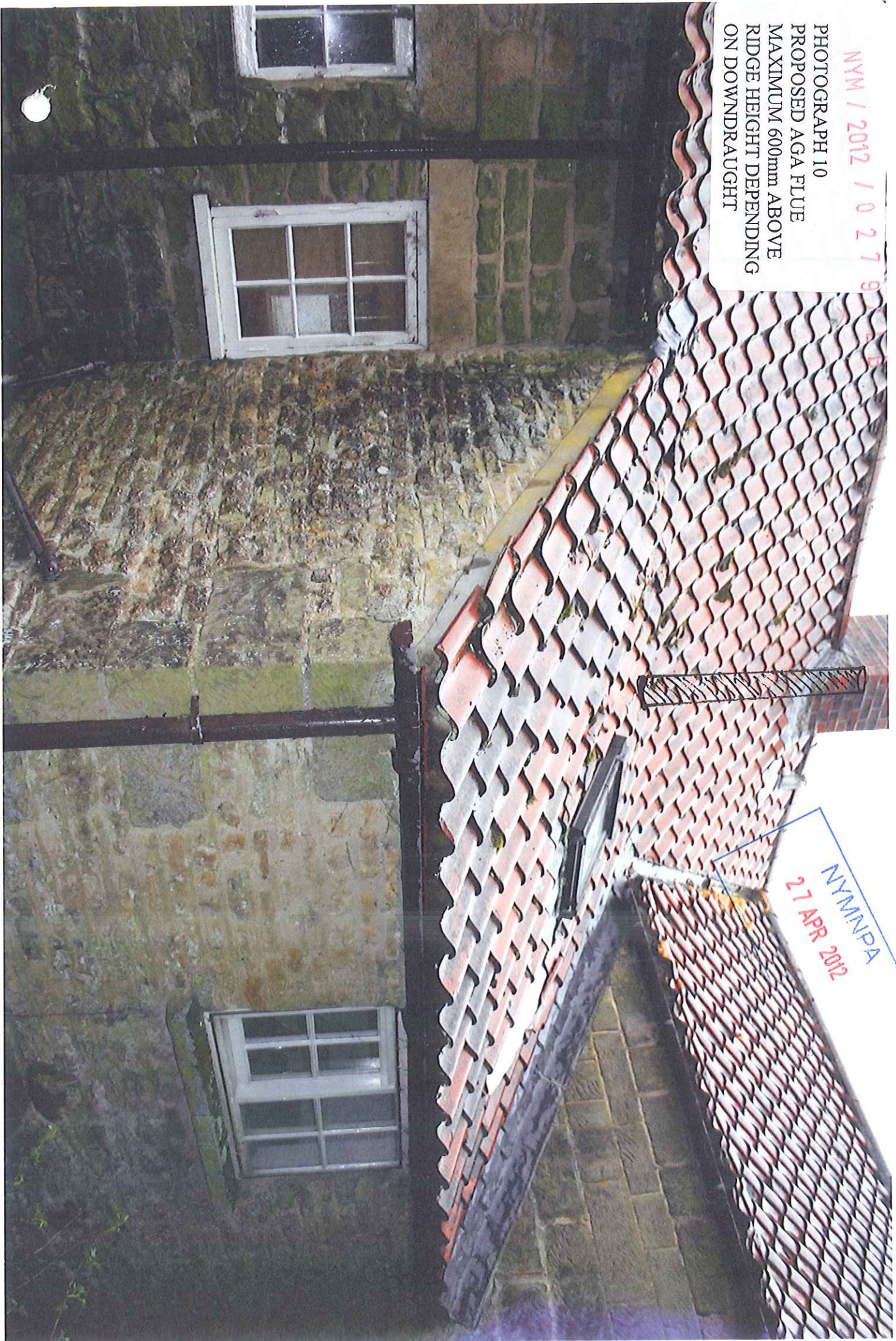

NYM / 2012 / 0 2 7 9 / L B

PHOTOGRAPH 11
PROPOSED FLUE FOR NEW
WOODBURNER MAXIMUM
600 mm ABOVE RIDGE

NYMNPA
27 APR 2012



Troutsdale Mill
Proposed Ground Floor Plan showing replacement window positions

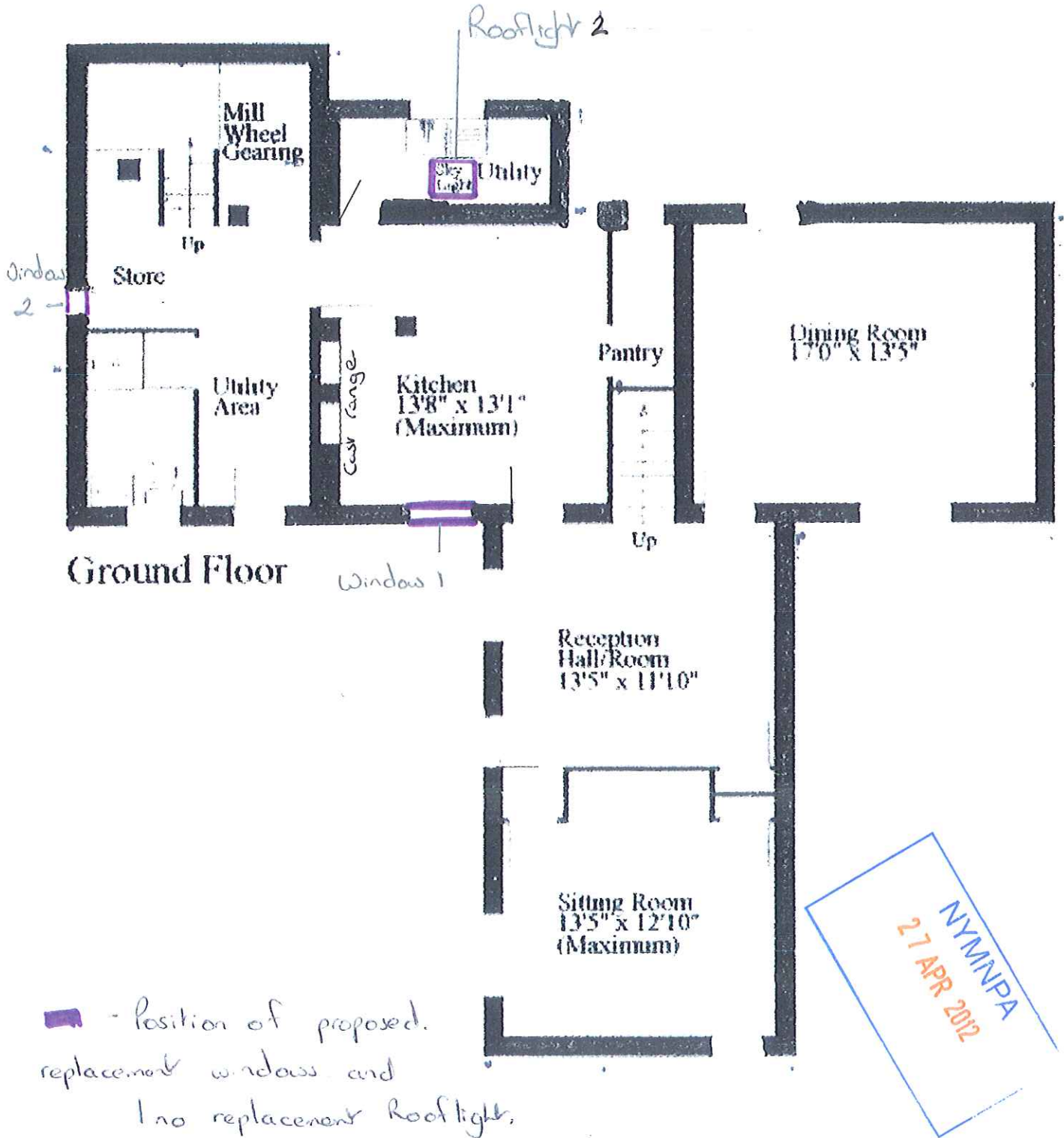

■ - position of proposed replacement windows and
no replacement Rooflight.

NYM/NPA
27 APR 2012

Troutsdale Mill
Proposed First Floor Plan showing replacement window positions

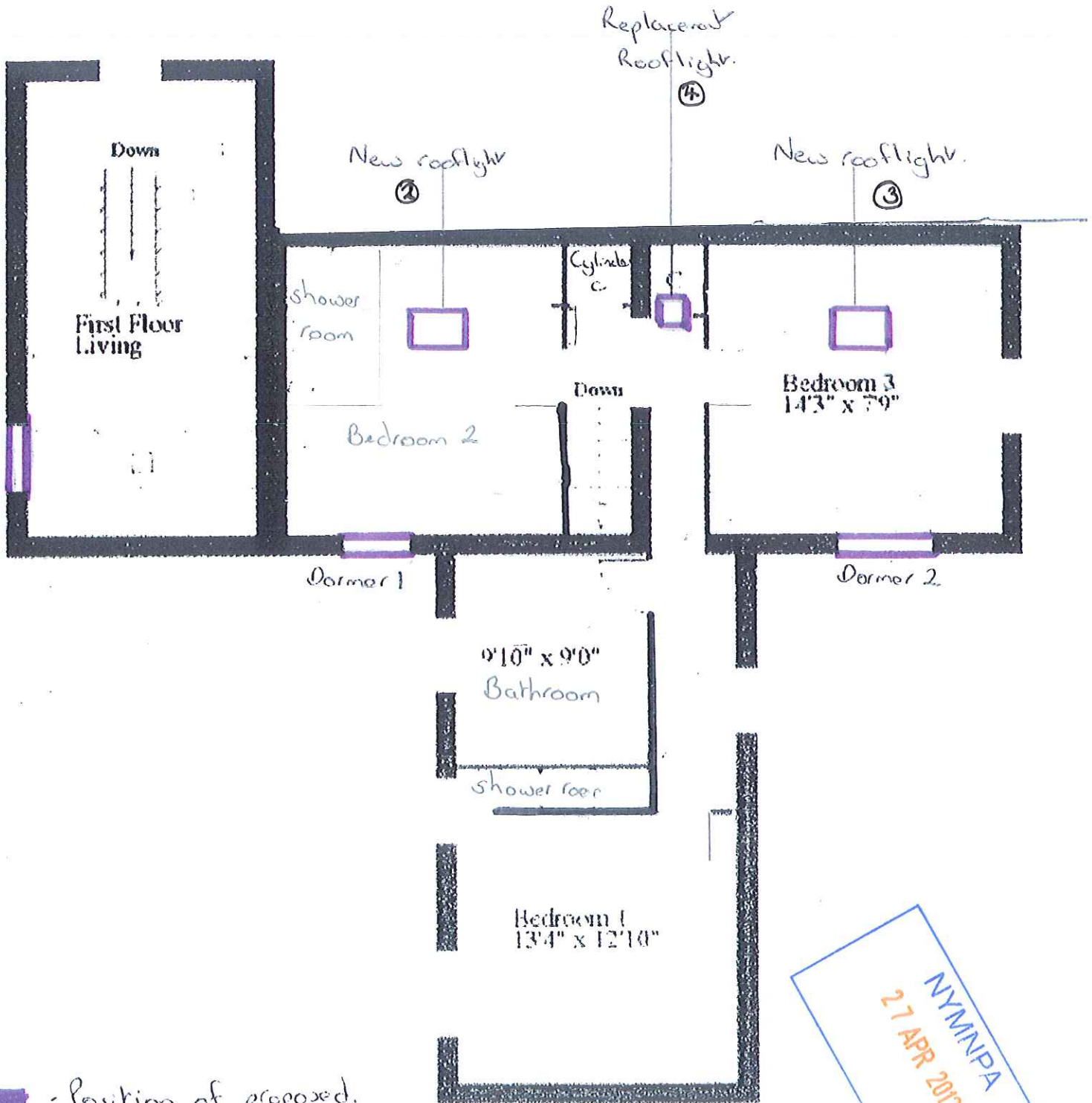

■ - Position of proposed replacement windows and 3 no. rooflight windows.

See accompanying photographs.
" " profiles from R. Taylors.

NYM/NPA
27 APR 2012

Troutsdale Mill
Proposed Roof Plan showing rooflight positions

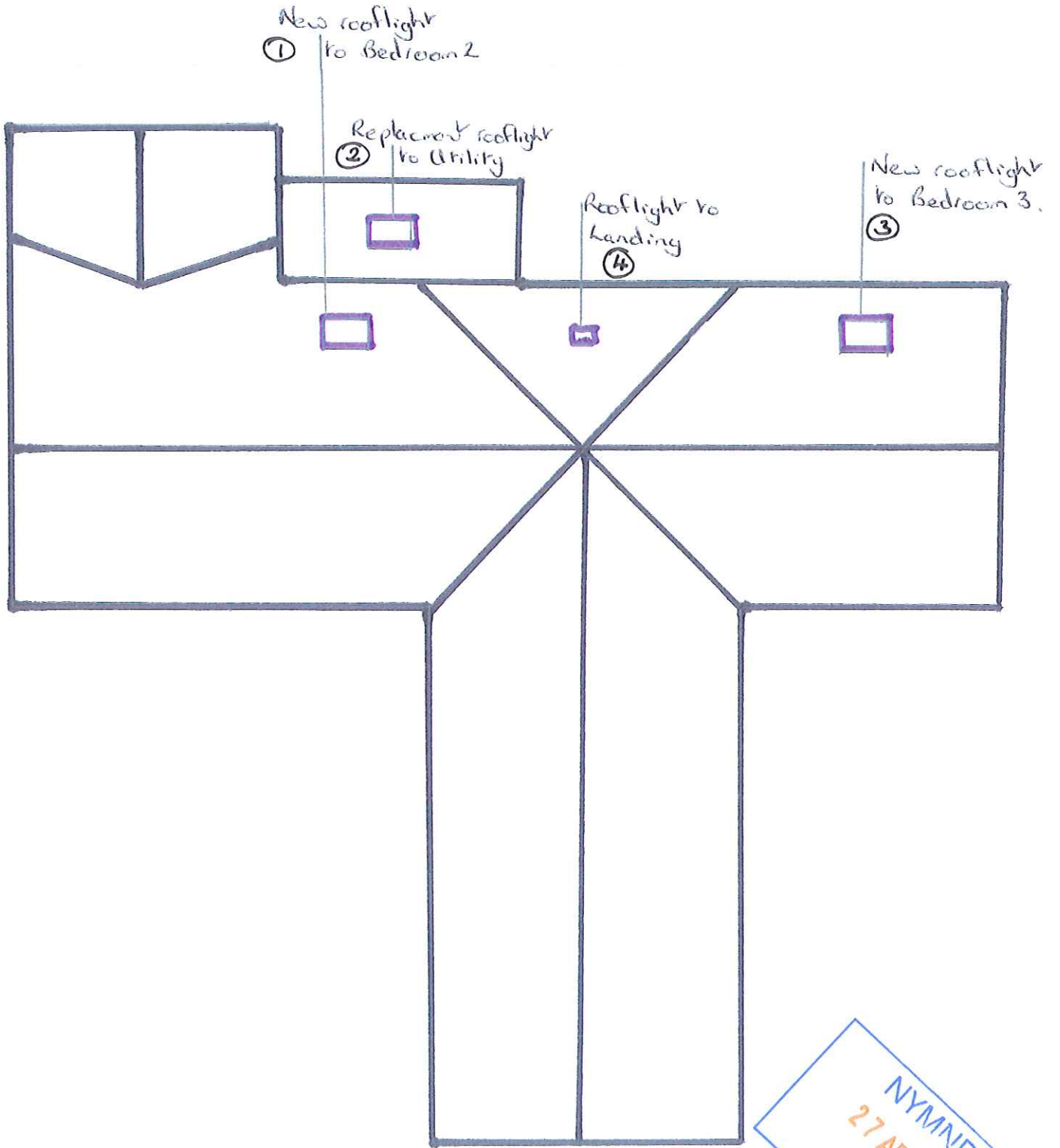

NYM NPA
27 APR 2012

S. TAYLOR & SON LTD

Hungate Joinery Works, Pickering, North Yorkshire. YO18 7DL

Tel: 01751 472143

Fax: 01751 477036

Timber sections for our standard casement windows
Showing opening sash (Fixed sash required in non-opening sections)

Applied glazing bars

4/16/4 (24mm) Planitherm low E Double Glazing.

No Trickle Vent - Please confirm with Building Control / Planners

NYM/NPA
27 APR 2012

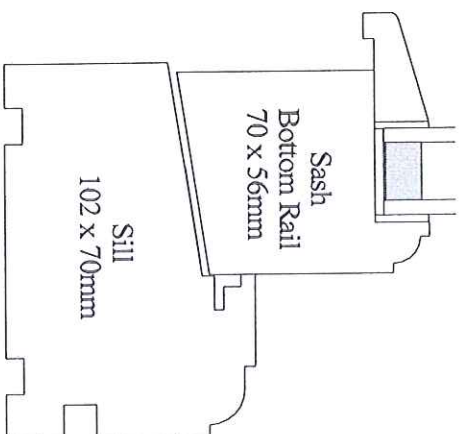
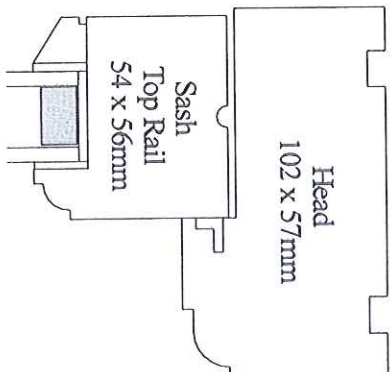
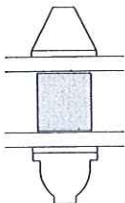
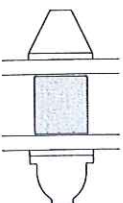
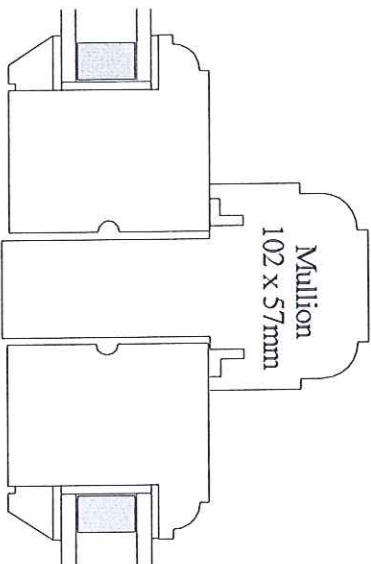
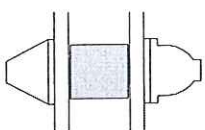
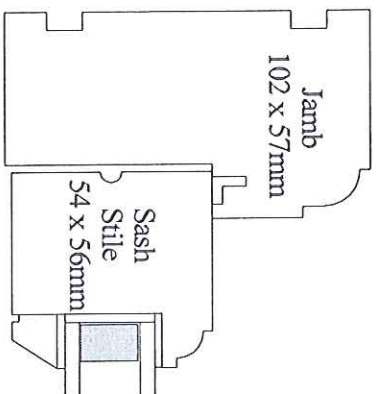

Scale 1 : 2

S. TAYLOR & SON LTD

Hungate Joinery Works, Recreation Road, Pickering, North Yorkshire. YO18 7DA

Tel: 01751 472143

Fax: 01751 477036

Drawing showing sections of our casement windows
With inset sashes
Rebated for single glazing.

NYM / 2012 / 0 2 7 9 / L B

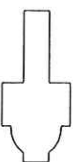
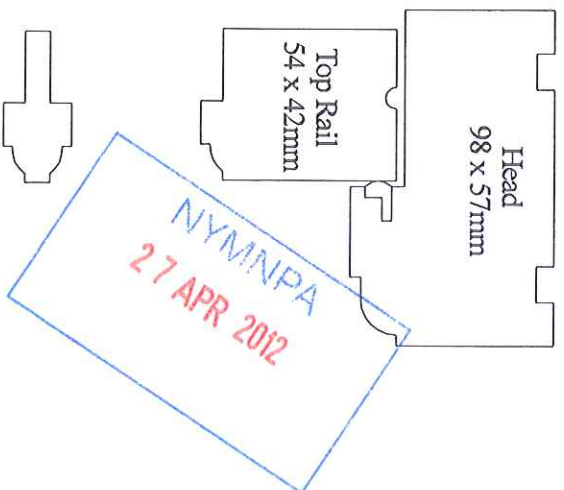
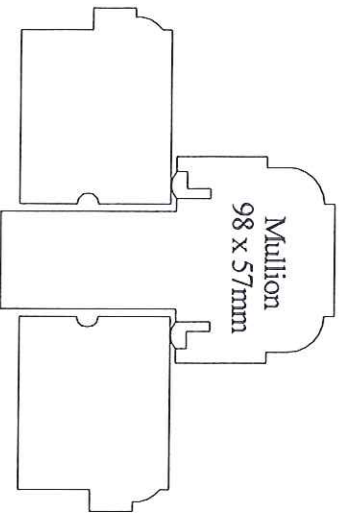
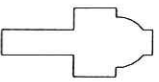
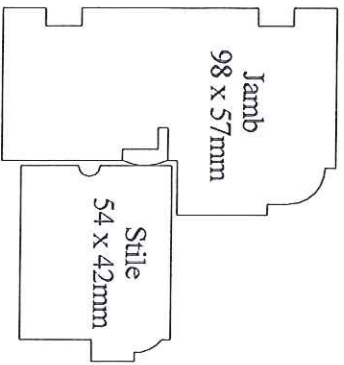

Glazing Bar
42 x 19mm

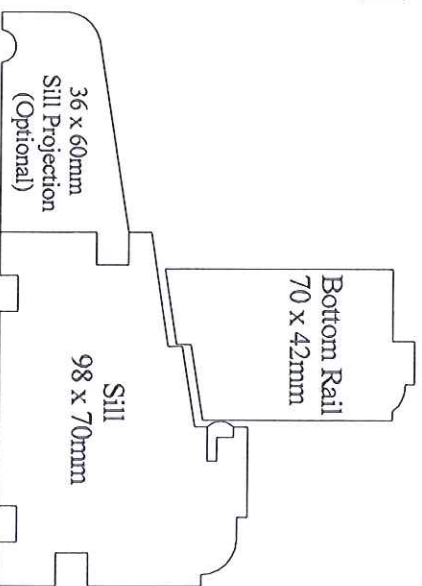

Scale 1 : 2

Mid size Diagrams with setting out

1 X Window - C (Kitchen)

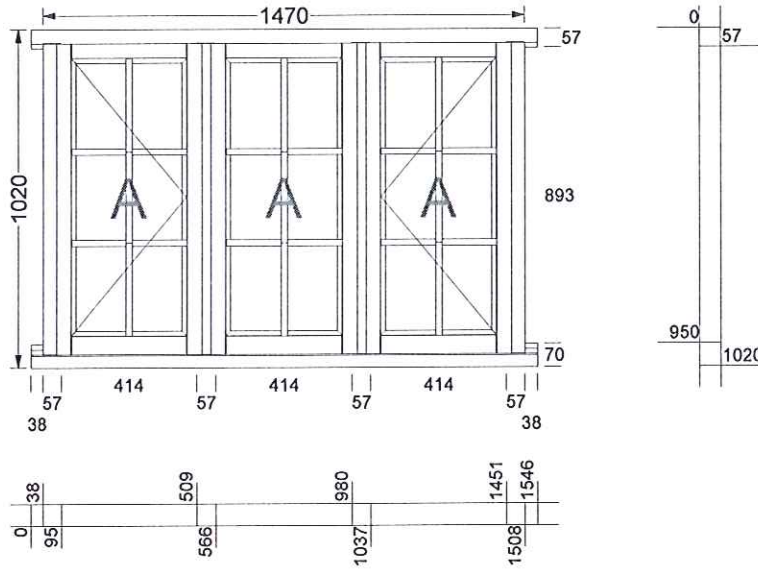

C
Side vent left sash, Side vent right sash, Fixed sash

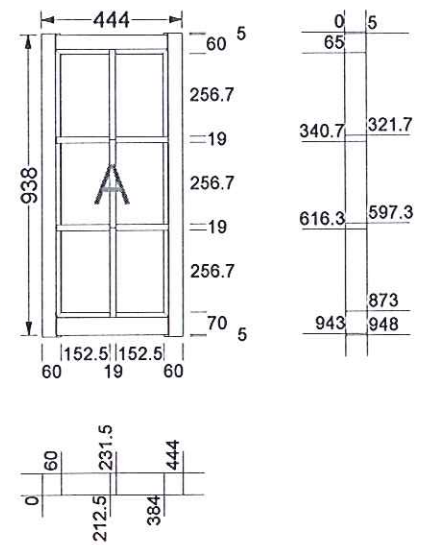

2 X Window - D,E (Dormers)

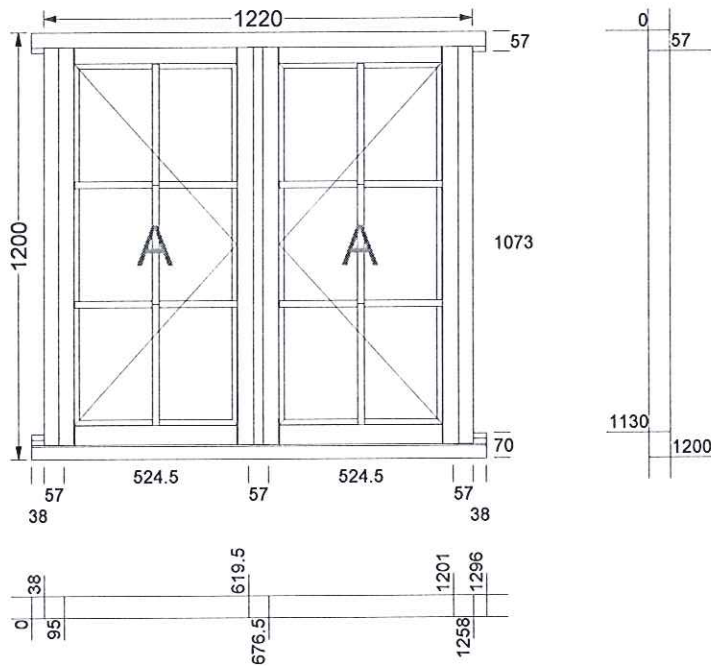

D,E
Side vent left sash, Side vent right sash

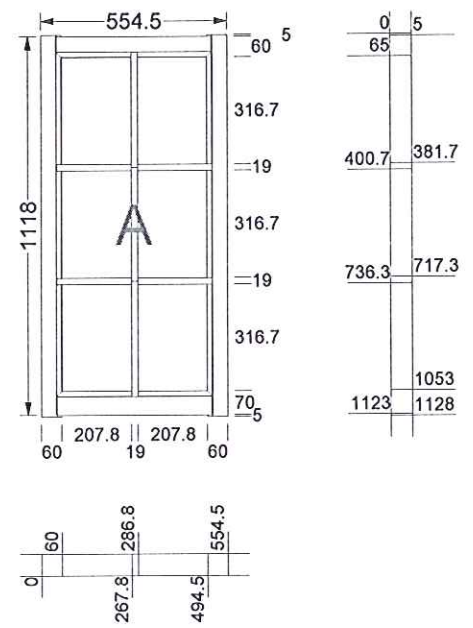

27 APR 2012

S. Taylor & Son Ltd

Mid size Diagrams with setting out

Client **Mr Kendall Andrew**

Job

NYM / 2012 / 0 2 7 9 / LB

1 X Window - A (Gable)

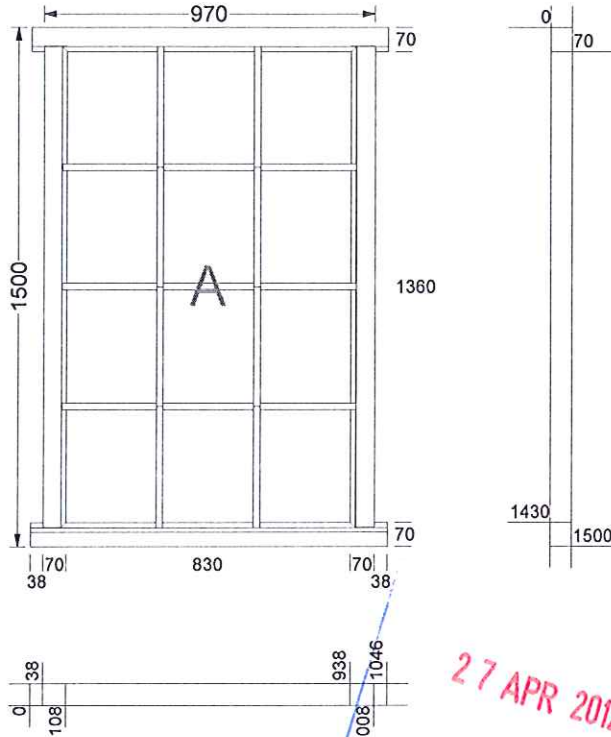

A Direct glazing

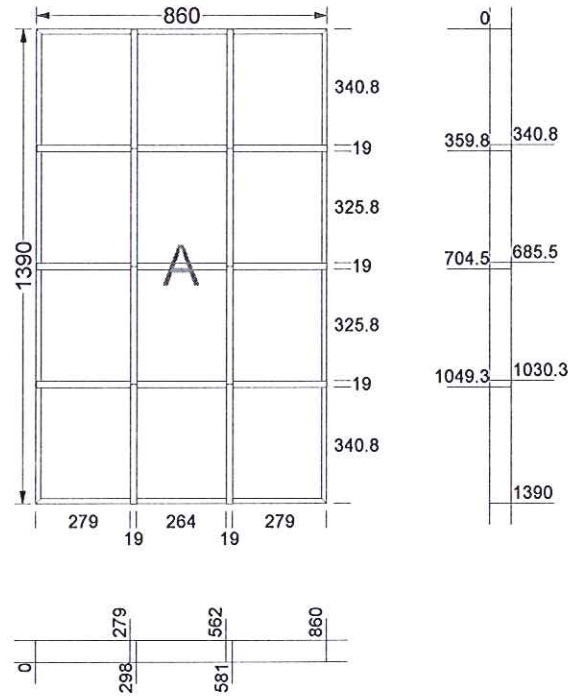

27 APR 2012

1 X Window - B (Gable)

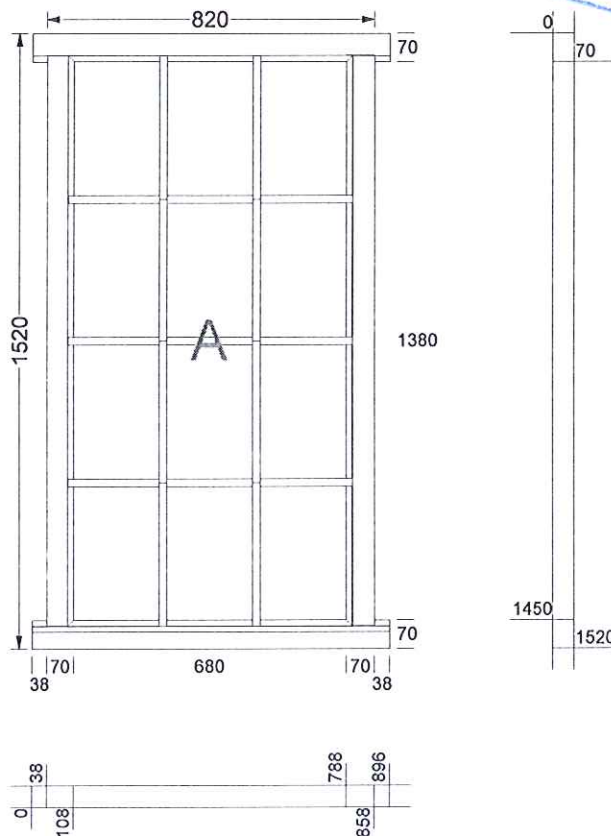

B Direct glazing

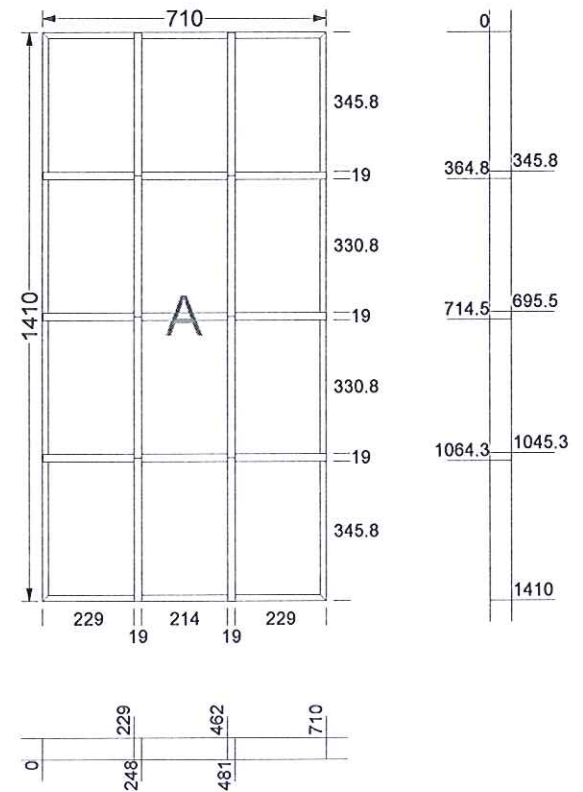

Top Hinged

Egress / Access

Side Hinged

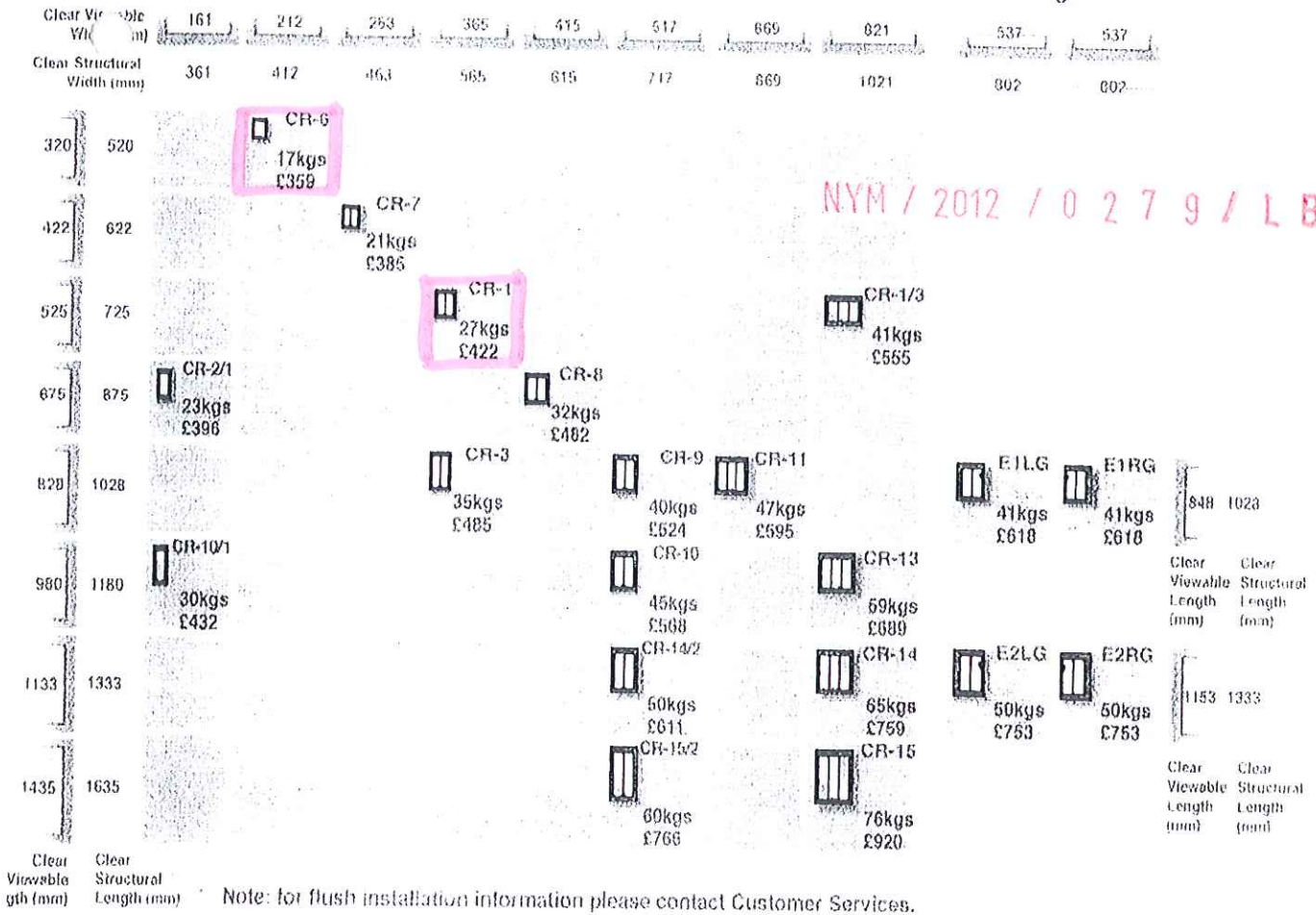

NYM / 2012 / 0 2 7 9 / L B

Rooflight sizes

Rooflight numbers 1,2 3

Structural width	565mm
Structural length	725mm
Viewable width	365mm
Viewable length	525mm

Rooflight number 4

Structural width	412mm
Structural length	520mm
Viewable width	212mm
Viewable length	320mm

NYM/2012
27 APR 2012

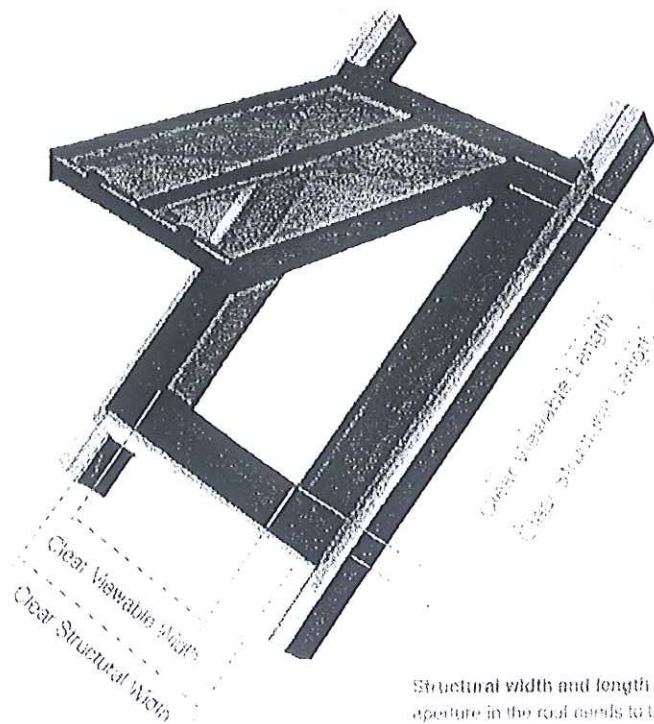

Structural width and length - this is the aperture in the roof needs to be formed by

Installation

[Request a Quote](#)

NYM / 2012 / 0 2 7 9 / L B

the Conservation Rooflight®

"Conservation continues to have a high profile in the building profession and the Rooflight Company's commitment to excellence in this field is well-recognised."
 Jack Pringle, Past President of the RIBA

the Conservation Rooflight® remains faithful to its Victorian heritage whilst embracing technical developments to stay ahead of Building Regulations.

Why specify the Conservation Rooflight®?

the Conservation Rooflight® is the original low profile skylight, combining the highest modern performance standards with an authentic traditional appearance. Favoured by English Heritage, the National Trust and planning / conservation officers, it is available in a wide range of standard sizes, along with the Bespoke Design Service.

- Traditional appearance and approval by Planning Authorities
- Faithful reproduction of Victorian cast iron rooflight
- Ultra-low profile, fine lines of steel and genuine glazing bar
- Complies with planning requirements for listed buildings and conservation areas
- Sizes for any application and a specials design service
- Favoured by the National Trust and English Heritage
- Silicone fronting replicating traditional putty
- Stepped glazing detail to give appearance of single glazing
- The Rooflight Company offers the widest range of sizes available with 17 top-hinged and 2 side-hinged options
- Now available – moisture resistant linings (for painting on-site) create a warm to the touch internal surface
- Now available – sleek blind system offering total blackout

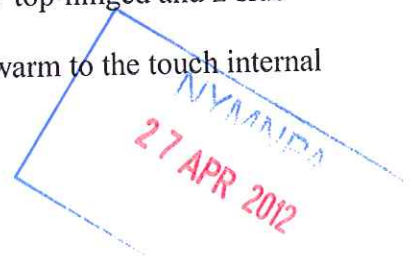
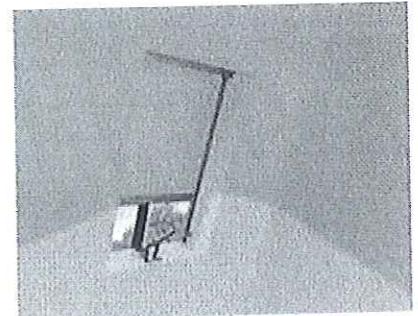

High standards of performance

- Standard double glazed unit exceeds current building regulation requirements on Part L
- High performance thermal lining (the patented Thermoliner®) helps reduce condensation
- Exceeds weather tightness test BS 6375: Part 1:2009 up to Hurricane Force 12
- High degree of air tightness
- The Conservation Rooflight® can provide ventilation in accordance with Part F of the Building Regulations

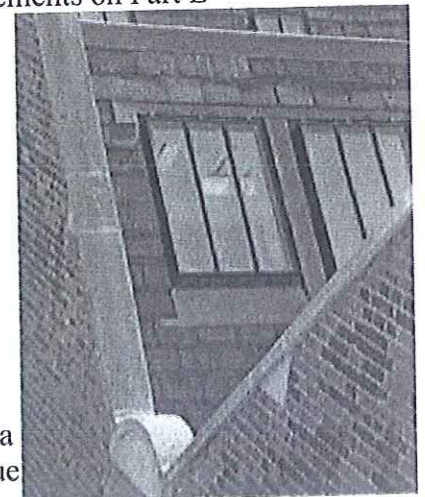

Glazing specification

We are currently changing our standard IGU specification to 4mm SGG PLANITHERM® TOTAL+ toughened inner with a 16mm argon cavity and a 4mm SGG PLANILUX® toughened outer, giving a glass centre pane U-value of 1.2W/m²K.

Other glazing specifications offering for example, improved thermal, acoustic or security properties as well as decorative finishes are also available.