

Wendy Strangeway

From: Helen Webster
Sent: 18 November 2015 17:19
To: Planning
Subject: FW: NYM/2015/0256/FL - Land south of A171 near Hawsker
Attachments: M sedman 1_500 Amended Nov 15.pdf; M sedman 1_500 Landscaping Nov 15.pdf; sedman site plan_201511181653.pdf; a3 plans sedman_201511181702_0001.pdf

Miss Helen Webster
 Planning Officer, Development Management

North York Moors National Park Authority
 The Old Vicarage, Bondgate, Helmsley, YORK, YO62 5BP
 t: 01439 772700 e: planning@northyorkmoors.org.uk w: www.northyorkmoors.org.uk

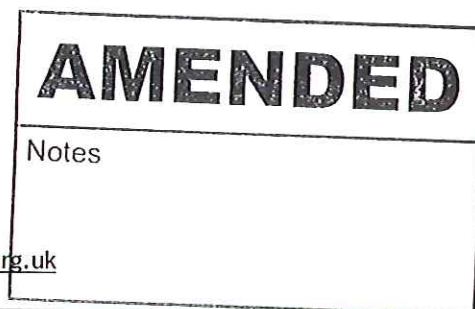

From: Davina Fillingham |
Sent: 18 November 2015 17:12
To: Helen Webster
Cc: [n](#)
Subject: RE: NYM/2015/0256/FL - Land south of A171 near Hawsker

19 NOV 2015
 CK

Dear Helen

Further to my email last week, I have attached the amended location plan and elevation plan to reflect the staged roof line.

All planting proposed within the landscaping scheme will be carried out to reflect the existing species mix that has been planted on the remainder of the land under the wildlife conservation scheme. The landscaping to the north east of the site involves denser planting of the old railway boundary with some Ash Trees added within the boundary line.

To the western boundary the landscaping involves planting up the existing hedgerow with new hedging to create a denser screening of the proposed development.

As discussed on site the landscaping to the south and south west involves an earth bund graduated into the landscape planted over with a Hawthorne and blackthorn field maple and Holly screening to reduce the impact of the proposed development on the landscape.

Please do not hesitate to contact me should you require any further information or wish to discuss any points further,

With kind regards,

Davina

Davina Fillingham BSc (Hon) MRICS FAAV NSch
 RICS REGISTERED VALUER

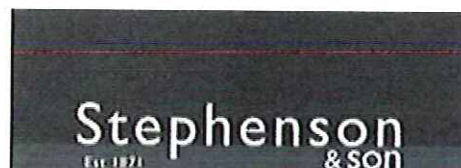

RURAL PROPERTY
 SERVICES

SALES

LETTINGS

AUCTIONS

DISCLAIMER

This email and any attachment is sent from Stephenson & Son and is for authorised use by the intended recipient(s) only. It may contain proprietary material, confidential information and/or be subject to legal privilege. It should not be copied, disclosed to, retained or used by, any other party. If you are not the intended recipient then please promptly delete this e-mail and any attachment and all copies and inform the sender either via email or phone 01904 489731.

We also make every effort to keep our network virus free. However, you do need to scan this e-mail and any attachments to it for viruses as we can take no responsibility for any computer virus which might be transferred by way of this email.

Thank you.

Stephenson & Son, York Auction Centre, Murton, York, YO19 5GF. VAT Reg. No. 170 5715 71



A171

Dismantled Railway

AMENDED

Notes

19 NOV 2015

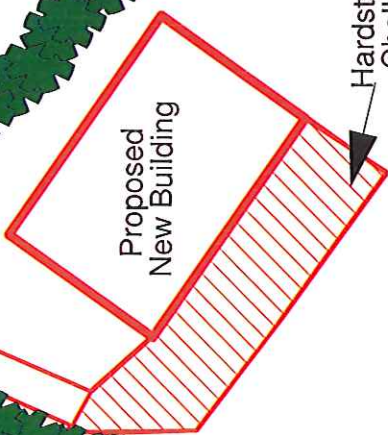

Hardstanding Chalk Area



Ordinance Survey © Crown Copyright 2015. All rights reserved. Licence number 100022432. Printed Scale - 1:5000



A177

19 NOV 2015

ed Railway

Planting up of existing hedge boundary comprising Hawthorne, Blackthorne, Field Maple and Holly. Further planting of Ash trees within the boundary line

Earth Banked area with landscaped planting over comprising Hawthorne, Blackthorne, Field Maple and Holly

Hardstanding Chalk Area

Proposed New Building

Planting up of existing hedge boundary comprising Hawthorne, Blackthorne, Field Maple and Holly.



AMENDED
Notes



Ordnance Survey © Crown Copyright 2015. All rights reserved. Licence number 100025432. Plotted Scale - 1:500



19 NOV 2015

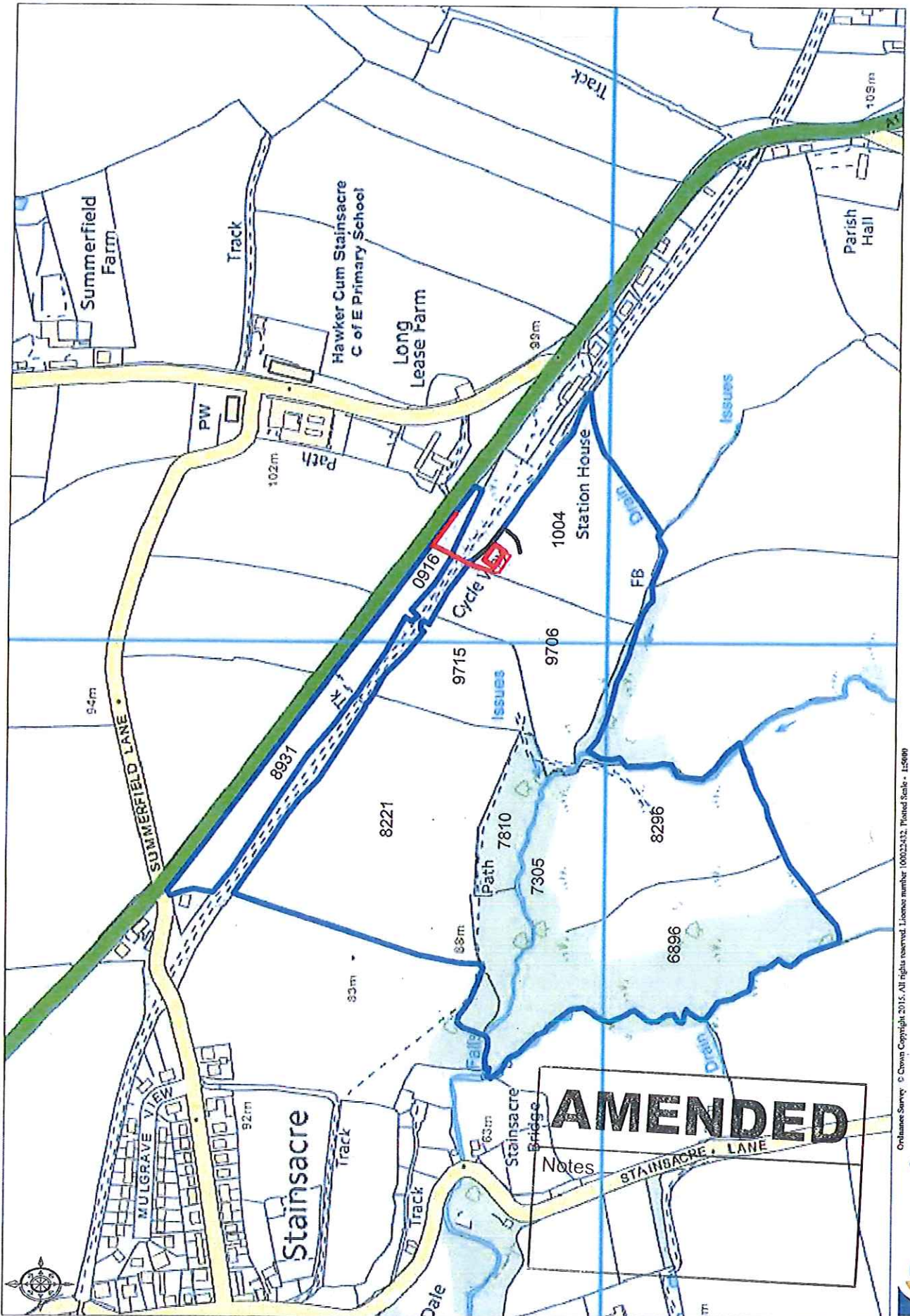

AMENDED
Notes

Ontario Survey © Crown Copyright 2015. All rights reserved. License number 100023432. Printed Scale - 1:5000



Proposed Agricultural Building
on land betwixt
Hawsker and Stainsacre
nr. Whitby

19 NOV 2015

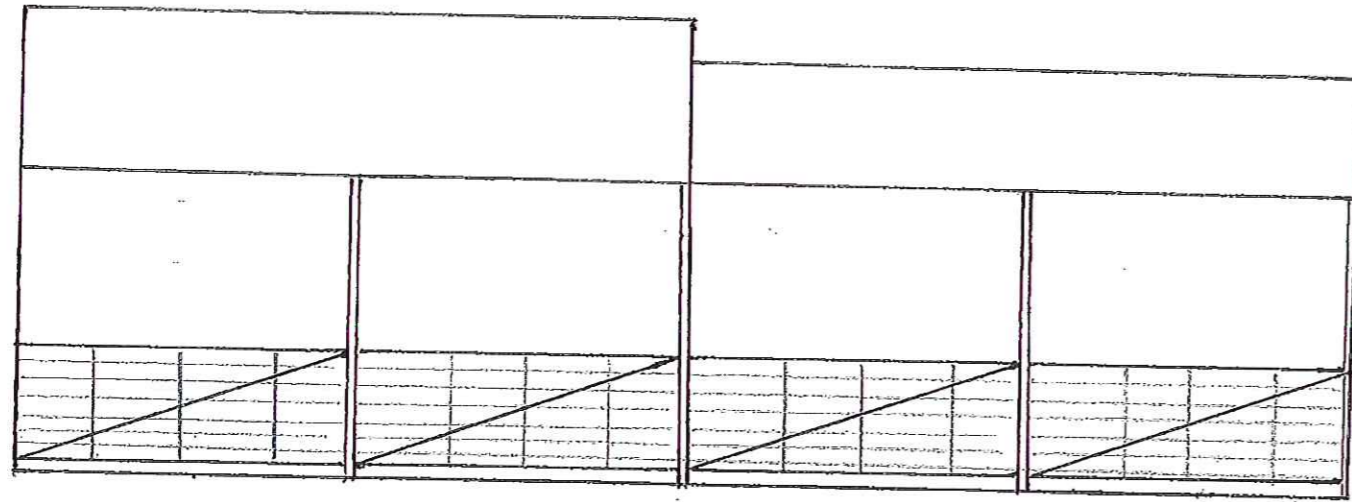

SOUTH WEST ELEVATION

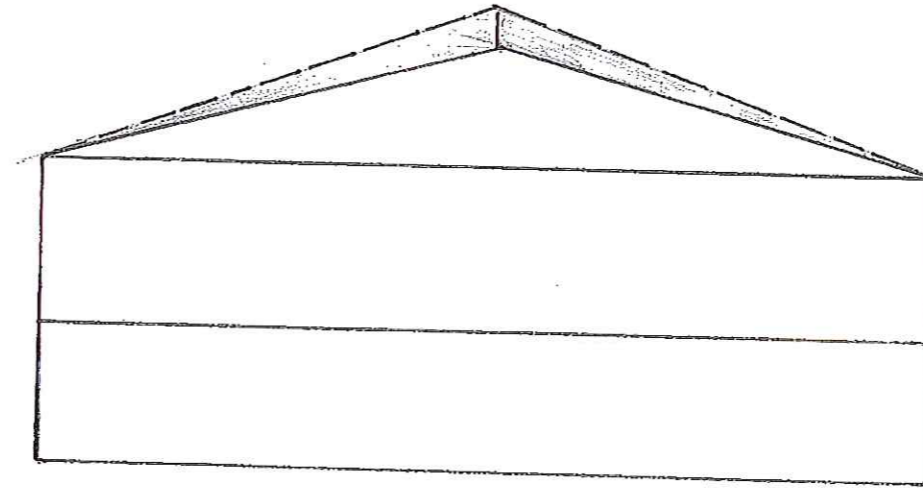

SOUTH EAST ELEVATION

AMENDED

Notes

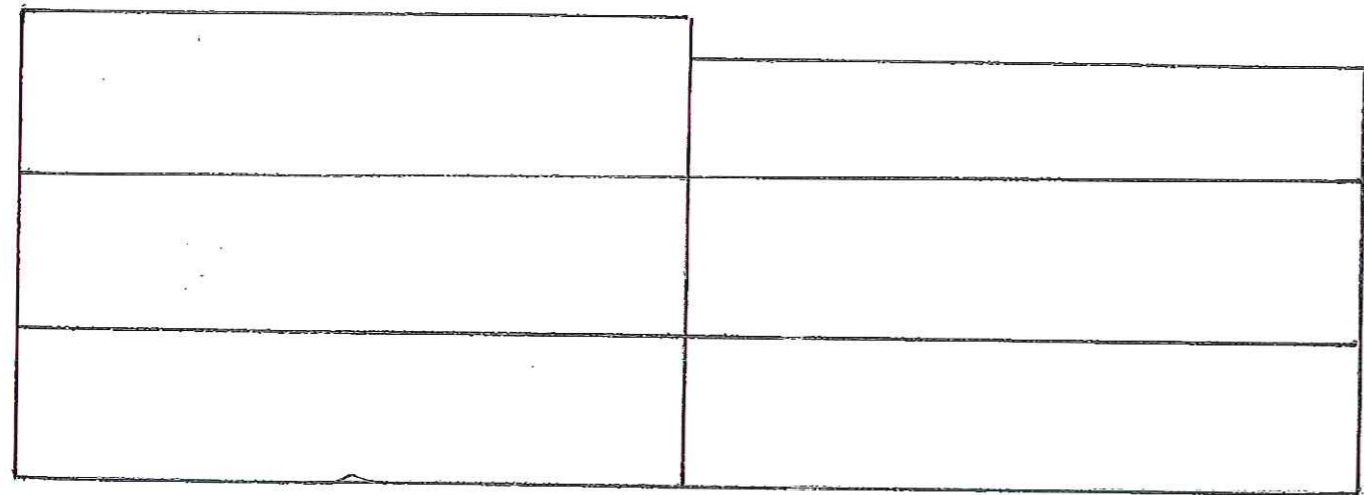

NORTH EAST ELEVATION

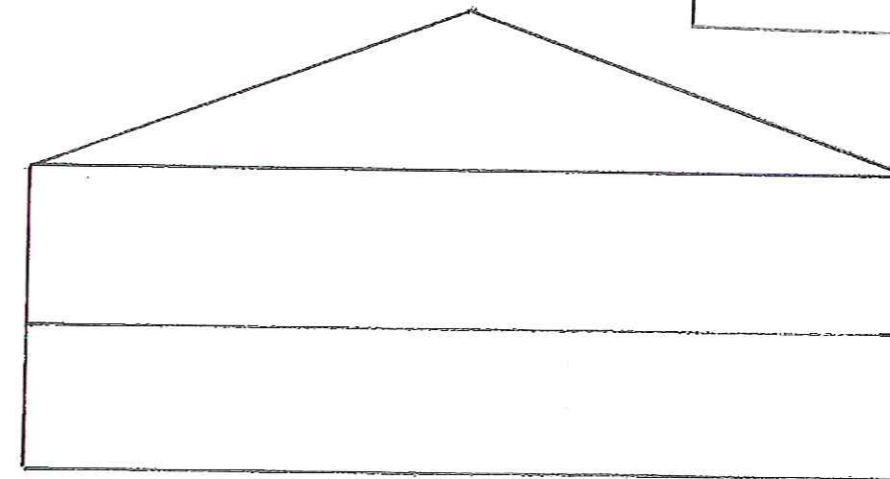

NORTH WEST ELEVATION

SCALE 1:100
Drawn A3
Date: amended Nov 2015