

PA  
-9 JUL 2015

SKETCH  
2.106-SK1

RICHARD AGAR ASSOC. LTD.  
BARCLAYS BANK HOUSE  
21A BAXTERGATE  
WHITBY  
NORTH YORKSHIRE  
YO21 2DU

**Notes**

A01. These notes are intended to augment drawings and specifications. Where conflict of requirements exists the order of precedence shall be as shown in the specification. Otherwise the strictest provision shall govern.

A02. This drawing to be read in conjunction with all other relevant engineers and architects drawings.

A03. Drawings not to be scaled. All dimensions to be checked on site by the contractor. Any discrepancies to be notified to the Engineer and further instructions obtained before work is commenced.

No part of this drawing may be reproduced, stored in a retrieval system or transmitted in any form or by any means without prior permission in writing from Bell Snoxell Building Consultants Ltd.

- 9 JUL 2015

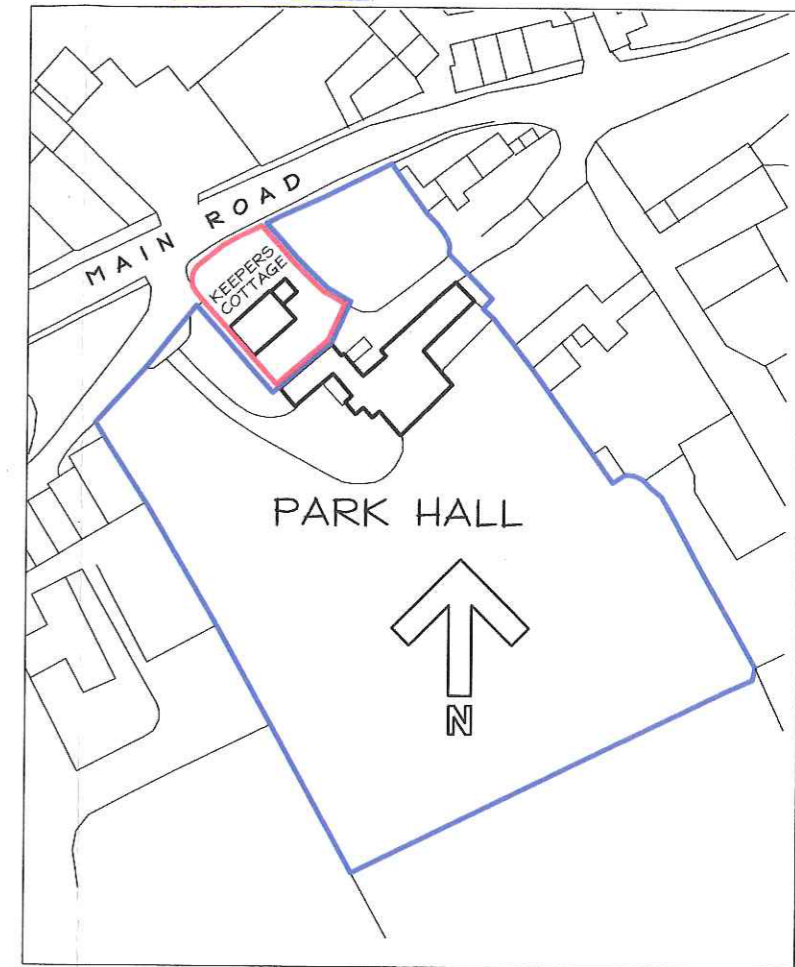

Location Plan 1-1250

**Bell Snoxell Building Consultants Ltd**

**RICS** the mark of property professionalism worldwide

Bell Snoxell Building Consultants Ltd  
Barclays Bank House  
Baxtergate  
Whitby  
North Yorkshire

<b>Project:</b> Proposed Refurbishment to The Keepers Cottage Park Hall, Aislaby, Whitby		
<b>Client:</b> Mr. D. Dalglish		
<b>Drawing:</b> Existing Site Layout & Block Plan		
<b>Date:</b> 25-6-15	<b>Scale:</b> 1:1250 1:200	
<b>Drawn By:</b> AHT	<b>Check By:</b> LS	<b>Approved By:</b> LS
<b>Drawing Status:</b> Planning		
<b>Job. no.</b> 5104	<b>Dwg. no.</b> 02	<b>Rev.</b>

Rev	Description	Date	CHK

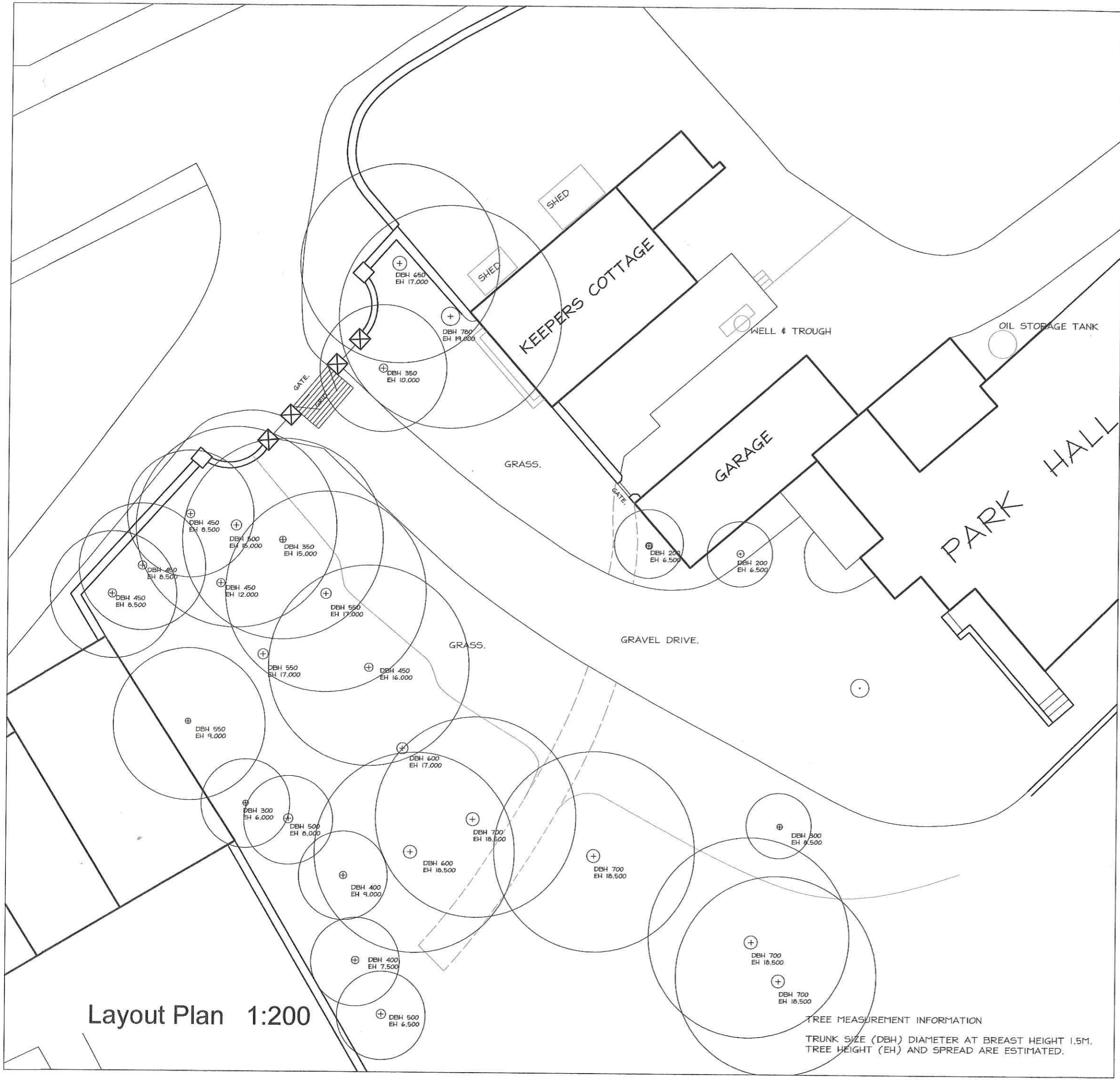

Layout Plan 1:200

**TREE MEASUREMENT INFORMATION**  
TRUNK SIZE (DBH) DIAMETER AT BREAST HEIGHT 1.5M.  
TREE HEIGHT (EH) AND SPREAD ARE ESTIMATED.

**Notes**

A01. These notes are intended to augment drawings and specifications. Where conflict of requirements exists the order of precedence shall be as shown in the specification. Otherwise the strictest provision shall govern.

A02. This drawing to be read in conjunction with all other relevant engineers and architects drawings.

A03. Drawings not to be scaled. All dimensions to be checked on site by the contractor. Any discrepancies to be notified to the Engineer and further instructions obtained before work is commenced.

No part of this drawing may be reproduced, stored in a retrieval system or transmitted in any form or by any means without prior permission in writing from Bell Snoxell Building Consultants Ltd.

WORKS TO BOUNDARY WALL AND ADJACENT TREES A, B and C.

This wall is subject to Grade 2 Listing. See Structural Engineers details and specification for remedial works.

GARDEN GATE.

Construct new garden entrance gate to cottage using salvaged stone from original side gate.

GARDEN FENCE.

Construct new 1000mm high timber palisade garden fence following the line of the existing concrete path.

GARDEN SHEDS

Remove existing sheds and other materials stored in the garden area.

WELL & TROUGH

Remove stone trough from the head of the well. Carefully clear stone around head of well, provide grating over well and re-set trough as before.

OIL STORAGE TANK

KEEPERS COTTAGE  
CONSERVATORY

GARAGE

PARK HALL

Clear weeds and other debris from the paved deck area outside the dwelling, re-use flagging and re-set on sand.

dwarf retaining walls to be carefully reconstructed and made stable

Hatched area is subject to Special Notice to remove trees A, B and C, in a Conservation Area with compensatory planting of 2 No. 1200mm high Hornbeam as shown.

NYMNDPA  
- 9 JUL 2015

**Bell Snoxell Ltd** Building Consultants

**RICS** the mark of property professionalism worldwide

Bell Snoxell Building Consultants Ltd  
Barclays Bank House  
Baxtergate  
Whitby  
North Yorkshire

Project: Proposed Refurbishment to The Keepers Cottage  
Park Hall, Aislaby, Whitby

Client: Mr. D. Dalglish

Drawing: Proposed Site Layout

Date: 25-6-15 Scale: 1:200

Drawn By: AHT Check By: LS Approved By: LS

Drawing Status: Planning

Job. no. 5104 Dwg. no. 07 Rev.

Rev.	Description	Date	CHK

**TREE MEASUREMENT INFORMATION**

TRUNK SIZE (DBH) DIAMETER AT BREAST HEIGHT 1.5M.  
TREE HEIGHT (EH) AND SPREAD ARE ESTIMATED.

