

## Hilary Saunders

---

**From:** Neil Duffield  
**Sent:** 27 May 2016 10:55  
**To:** Hilary Saunders  
**Subject:** NYM/2016/0265/cvc North Bridge Farm E10700-40 nymnp finishes 27\_05\_16  
**Attachments:** D10700-02.1F.pdf

Morning Hilary,

Please see attached the amended drawing D10700-02.1F.

Our clients have amended the detail as shown, in particular with respect to:-

Condition 7- External Light to the Gable of Building B removed

Condition 19 - Hard surfacing; Paving setts omitted and the areas of compacted stone extended. In terms of a colour this is likely to be clay/buff but our client is happy to provide a sample on site. In terms of the delineation for parking Bays this is provided by reclaimed timber sleepers, our clients will provide dwarf stone walls if preferred.

I trust these details allow discharge of the above but please do not hesitate to contact me if further information is required.

Kind regards  
Neil



imaginative architecture + engineering design

**bhd**  
partnership

Airy Hill Manor, Whitby, North Yorkshire, YO21 1QB | T: 01947 829317 | F: 01947 820010 | E: general@bhdpartnership.com | www.bhdpartnership.com

The information contained in this email is intended only for the person or entity to whom it is addressed and may contain confidential and/or privileged material. If you have received this email in error please note that any review, retransmission, copying, dissemination or other use of, or taking of any action in reliance upon its contents is prohibited. If you are not an intended recipient please delete the material from any computer that may have it and contact BHD Partnership IT Personnel on 01947 829317, thank you for your co-operation.

The contents of an attachment to this email may contain software viruses which could damage your computer system. We cannot accept liability for any damage which you sustain as a result of software viruses, you should carry out your own virus checks before opening any attachment.

**BHD Partnership, Airy Hill Manor, Whitby, North Yorkshire, YO21 1QB**



# AMENDED

Notes

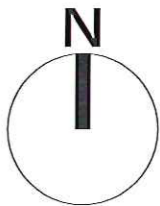

KEY:

- Clay pantile roofing
  - Natural stone paths  
Reclaimed flags where possible
  - Access and Parking- Compacted stone/ clean rubble  
Parking Bays -Edged with reclaimed timber sleepers
  - Grassed
  - Low level shrubs. Final landscape scheme to be secured by planning condition.
  - External bulkhead light, PIR operated LED units.
- Hard landscaping to be completed as the 3 dwellings are occupied and phased as such
- Bin Stores formed with stone walls, max height 1m

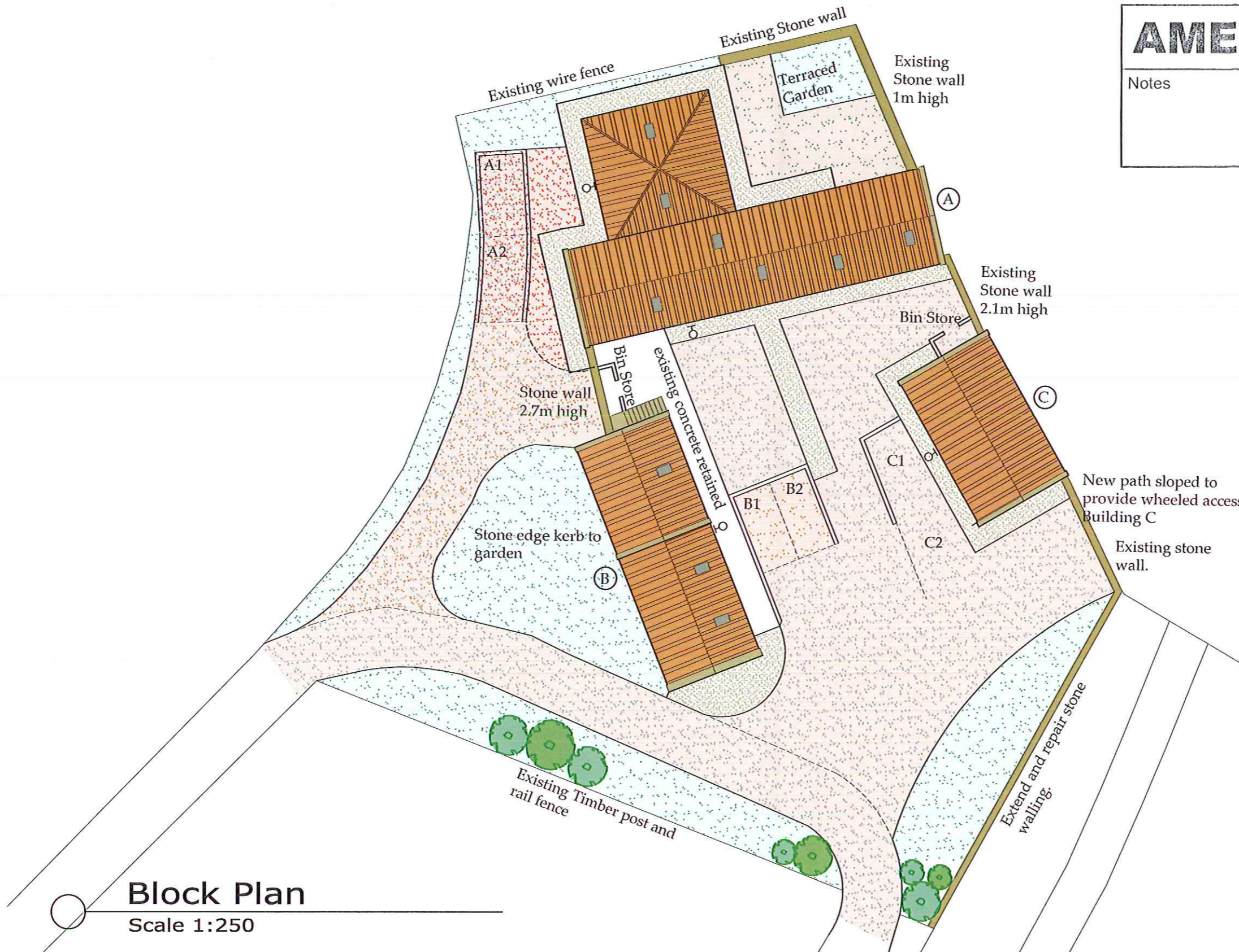

## Block Plan

Scale 1:250

NYMNP

27 MAY 2016

**b h d partnership**

Airy Hill Manor, Whitby, North Yorkshire, UK, YO21 1QB.

DO NOT SCALE from this drawing. Only figured dimensions are to be taken from this drawing.  
 The Contractor must verify all dimensions on site before commencing any work or shop drawings.  
 The Contractor must report any discrepancies before commencing work. If this drawing exceeds the quantities taken in any way, the Technician is to be informed before work is initiated.  
 Work within The Construction (Design and Management) Regulations 2007 is not to start until a Health & Safety Plan has been produced. This drawing is Copyright and must not be reproduced without consent of BHD Partnership Ltd

REV	DATE	BY	AMENDMENT	CHKD	APVD
F	26/05/16	nid	Finishes alterations		
E	08/04/16	CE	Additional detail, lighting and phasing.	NID	
D	10.04.15	CE	Key added	NID	
C	07/04/15	CE	Colour added	NID	
B	10/03/15	CE	Bin stores added	NID	
A	19/02/15	CE	Issued for approval	NID	

CLIENT: <b>Mr Atkinson</b>			
PROJECT: <b>North Bridge Farm Dowdale Rd, Staintondale</b>			
A3	DRN: C Eynon	DATE: 19/02/15	
SCALE: As shown	ISSUE: Preliminary		

DRAWING TITLE:  
**Proposed  
Block Plan**

DRAWING NR:  
**D10700-02.1**

REV:  
**F**